



# DKW NZ 350-1

## HDM35268

HD Models  
Via Filippo Nicolai, 24  
00136 - Roma

+39 06 39736835  
infohdmodels.it  
www.hdmodels.it

1/35



3D Design and Development for  
HD Models by F. De Petrillo

**HD**  **MODELS**

# DKW NZ 350-1

## HDM35268

### The Story

During the war the production of the company was restricted from the spectrum

125 - 500 cc of different types to just two models - NZ 350/NZ 350-1 and RT 125.

The NZ 350 was adopted for army service and became the "middle-class 350 cc

motorcycle" in the Wehrmacht's catalogue. The machine soon became known as "Das Motorrad der Kradmelder" - the dispatch rider's motorcycle. Many civil NZs were

confiscated and repainted for the Wehrmacht. All NZs produced for the Wehrmacht had a WaA stamp at the level of the steering head.

In 1943 the standard NZ 350 received its first major facelift. Redesigned were the

mudguards, a cyclone airfilter and a smaller headlamp, a mudknife on the right subframe, rear back braces and a smaller headlamp, HASAG 130 MT which came from the RT 125. This was done because the former HASAG 165 headlight showed difficulties in the field. The tank came without the knee pads of the NZ 350. The first NZ 350/43 versions had the big front mud guard of the civilian model. The later versions had the petrol cap with filter, as the 350-1, and the Hella 130 headlight, which was later changed for the reinforced Bosch 130 on the 350-1.

The NZ 350/43 must be seen as a development from a civilian motorcycle to a test model for its follower the NZ 350-1, which was produced only for the Wehrmacht.

The air cleaner was also changed and a new style air cleaner was mounted. Instead the previous simple round air cleaner, now a self encased centrifugal air cleaner was

mounted. This was a major step forward in design and was way ahead above the NZ 350 version.

In the beginning of 1944 another facelift was made, when the NZ 350/1943 received an engine block that was made from cast iron and number of other modifications.

This model was named the NZ 350-1.

The kit is developed and designed for easy assembly, the parts are extremely detailed and some are small in size. Use glues suitable for resin such as cyanoacrylate, tools such as tweezers and well-sharpened modelling knives, being careful not to hurt yourself during assembly.

Have fun modelling friends!

# Parts List

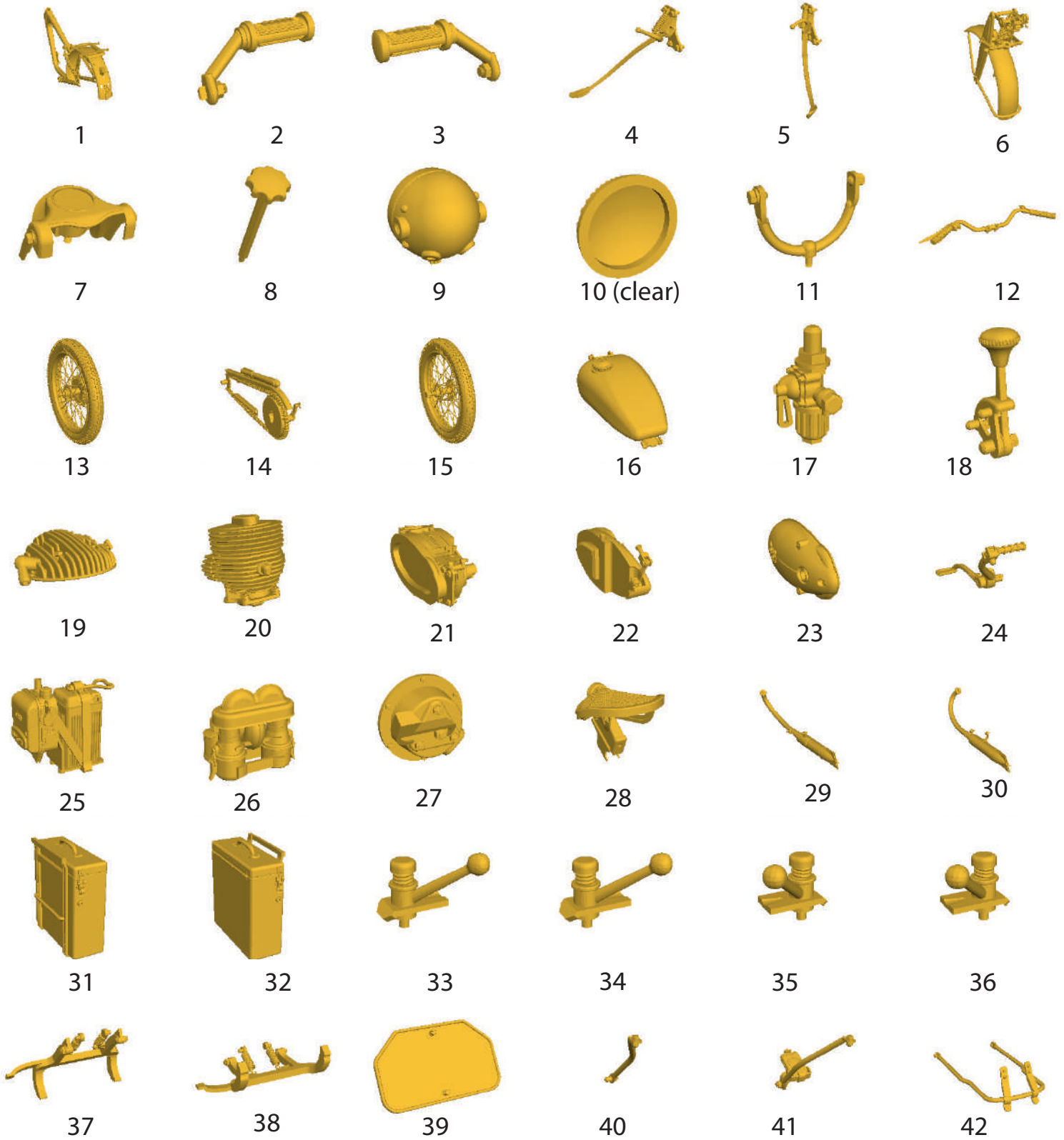

# Parts List

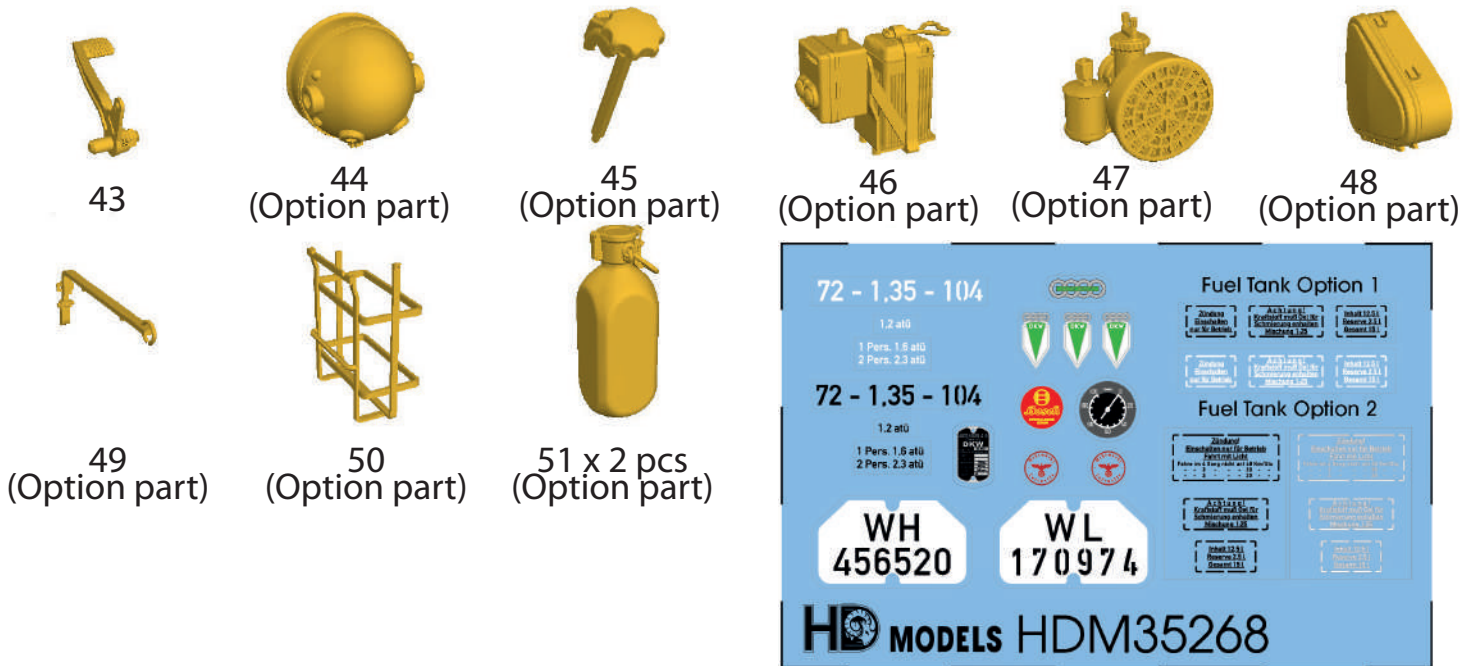

The kit parts are placed in three protection boxes that serve to protect them during transport. In order to detach the parts more easily, the two vertical walls of the protection boxes can be removed with a slight outward movement. Afterwards, the parts can be detached from the holders with a sharp knife or cutter tweezers such as our Code HDMT001.



Step 1. Take the protection box from the base

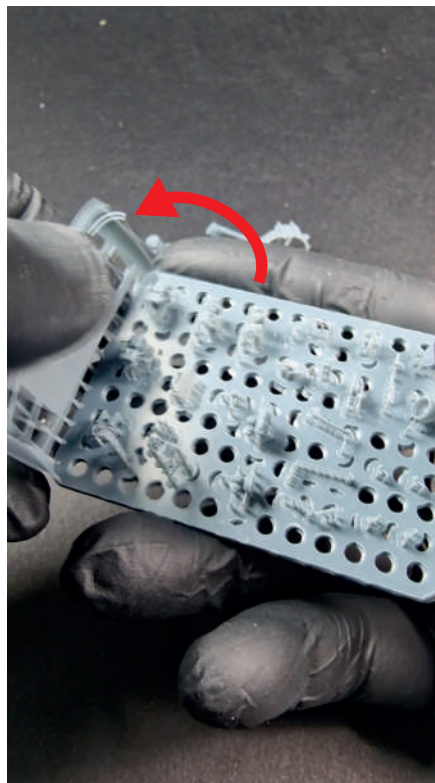

Step 2. Take the edge of the vertical wall of the protection box

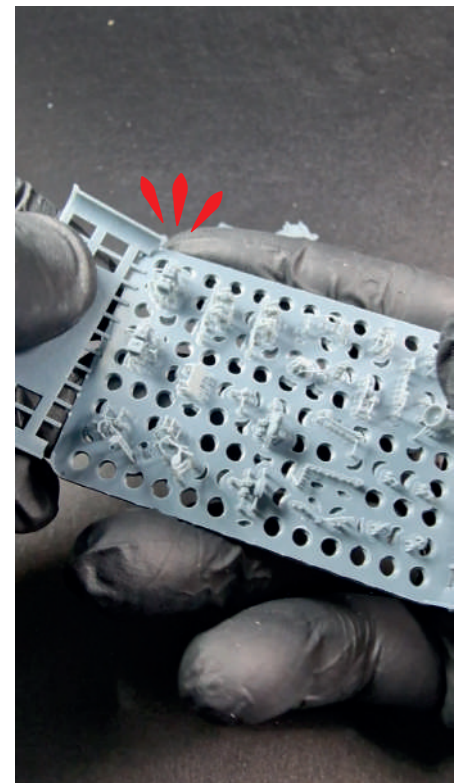

Step 3. Pull the vertical opening outwards and detach it from the base

# Kit Assembly

19



20



21



**STEP 1**



**26 (Military Air Filter)**



Option Part  
(Civilian Air Filter)

47

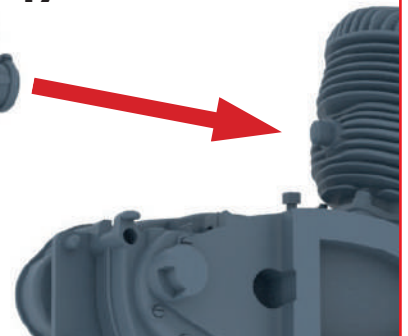

**STEP 2**

# Kit Assembly

**25 (Late Bobbin Case)**

Option Part  
(Early Bobbin Case)

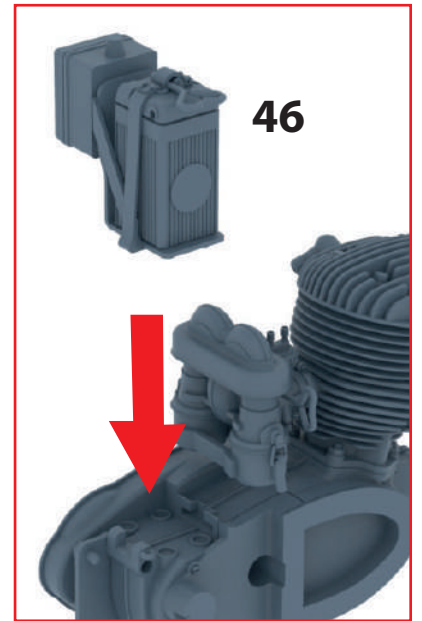
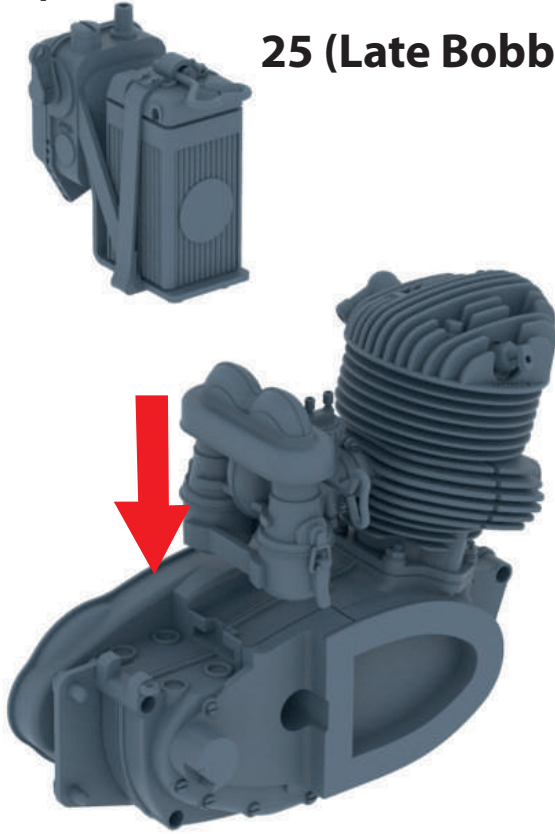

**STEP 3**

**23**

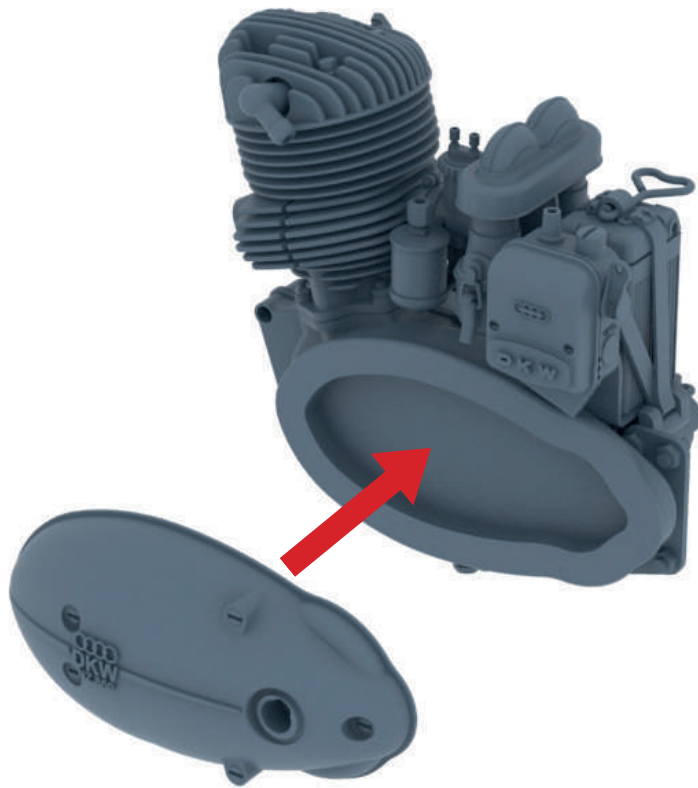

**STEP 4**

# Kit Assembly

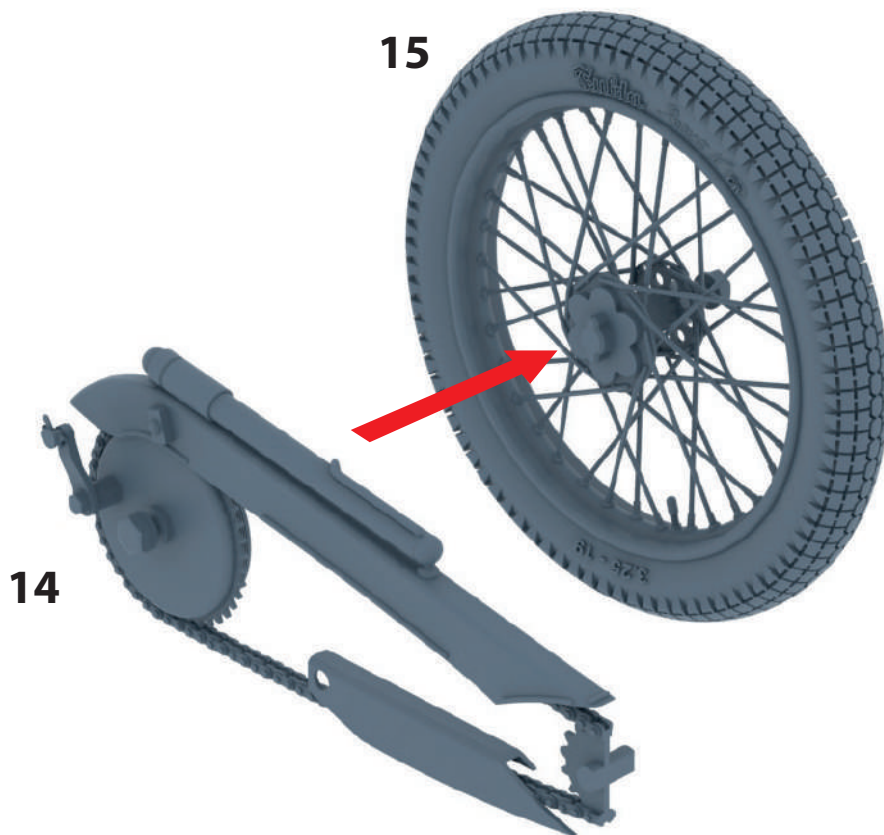
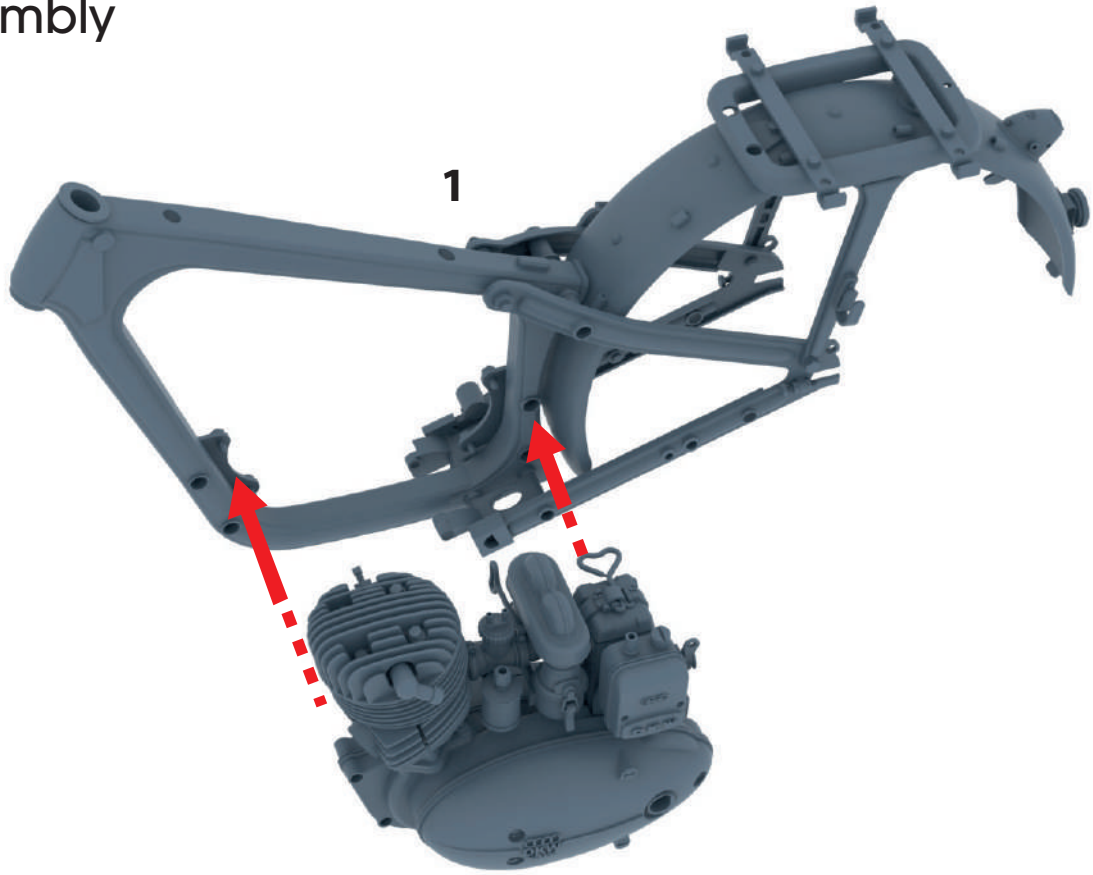

# Kit Assembly

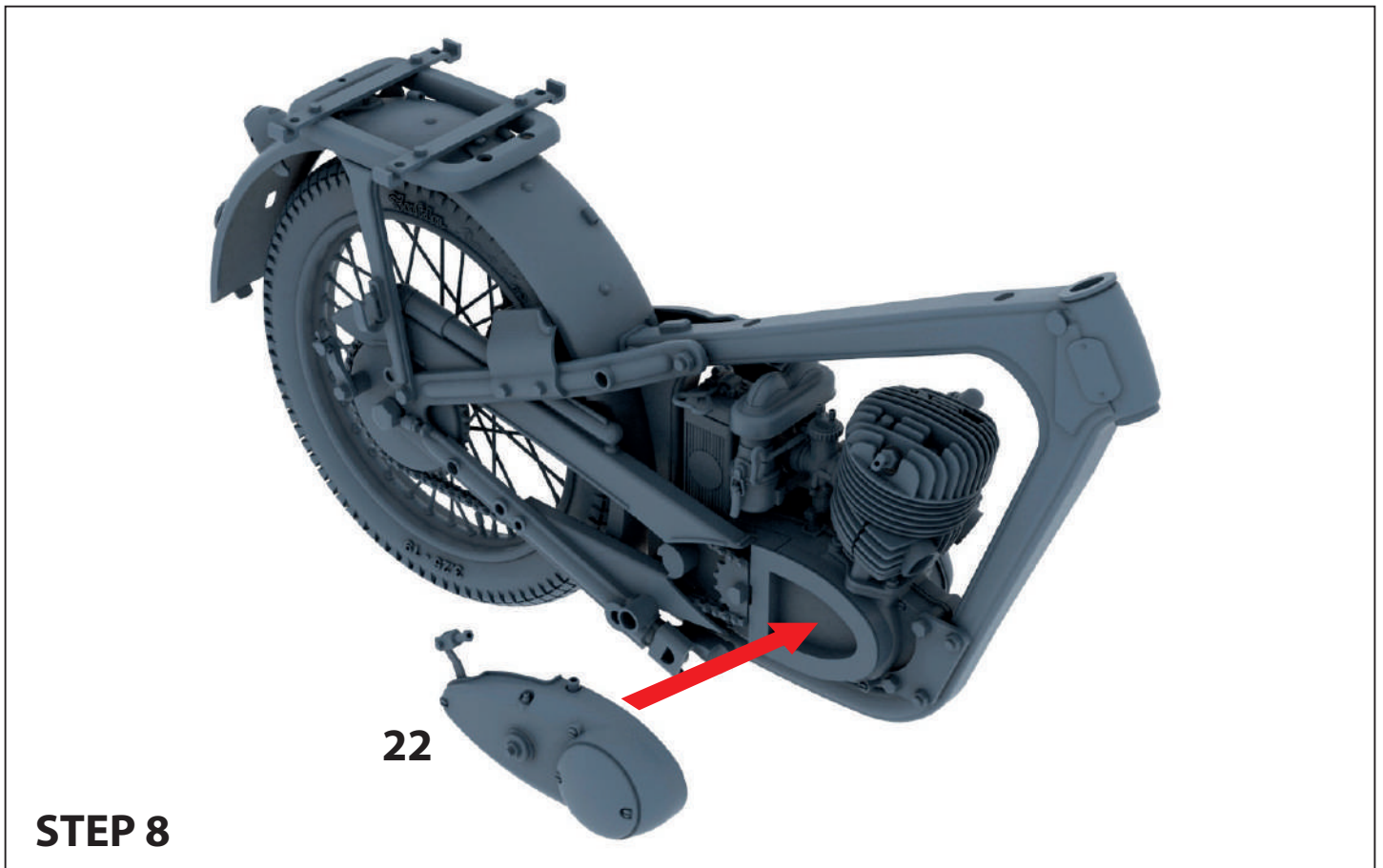
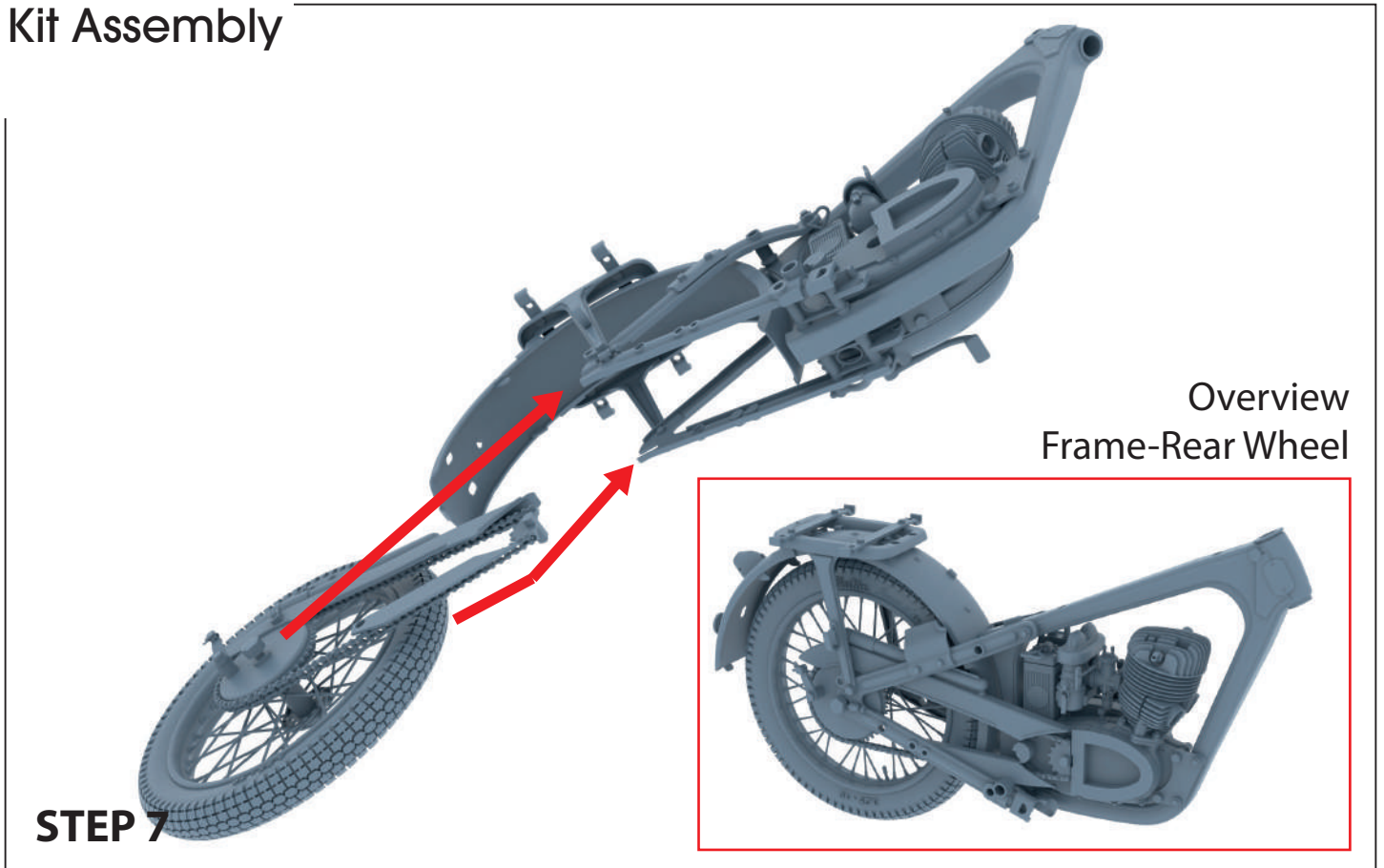

# Kit Assembly

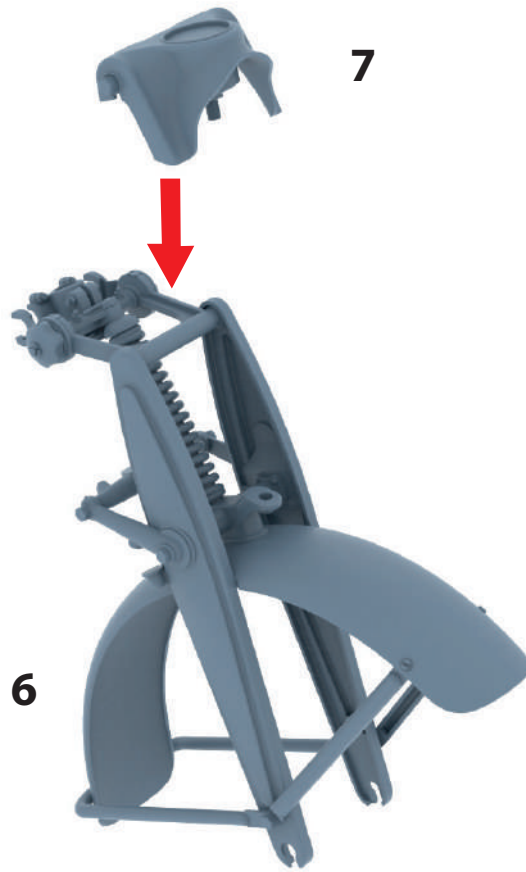

**STEP 9**

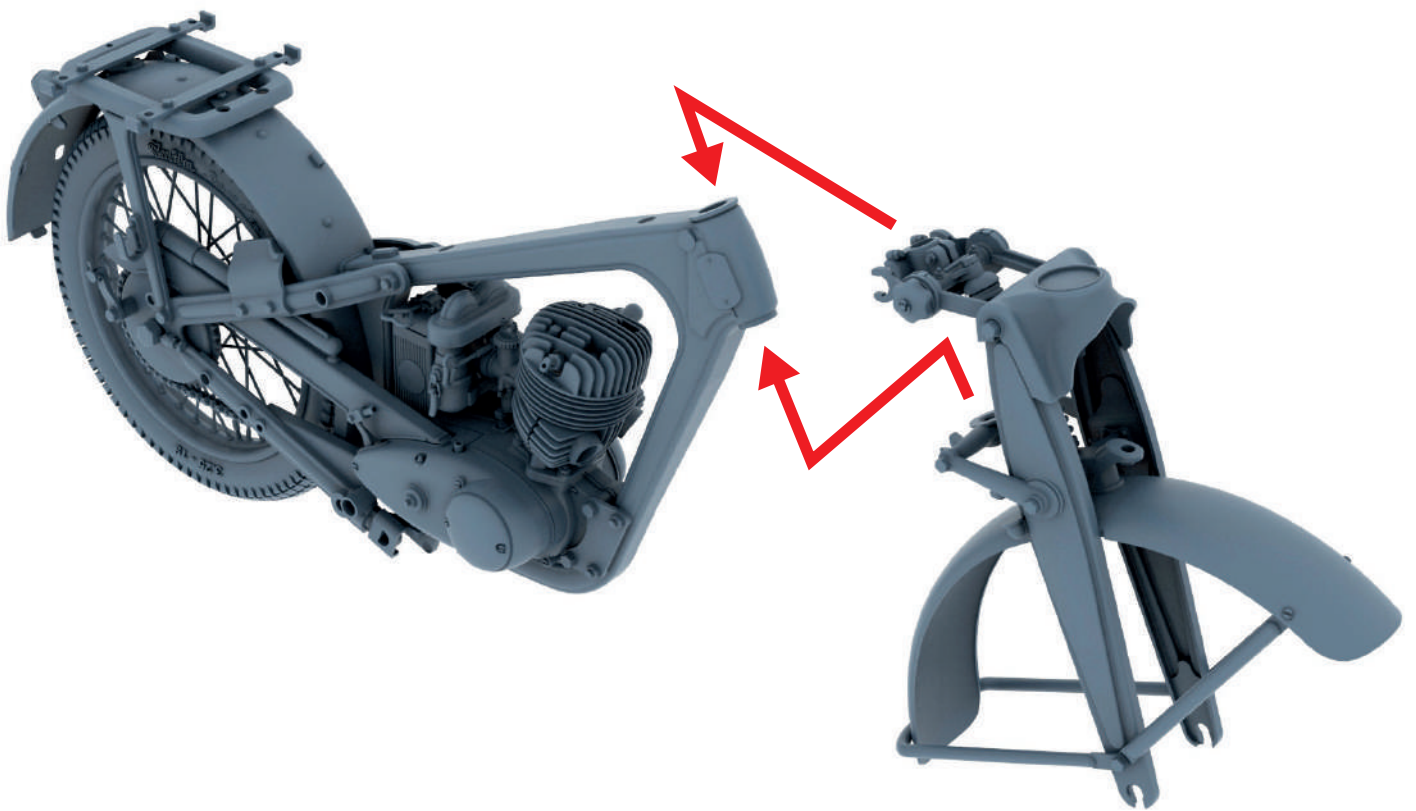

**STEP 10**

# Kit Assembly

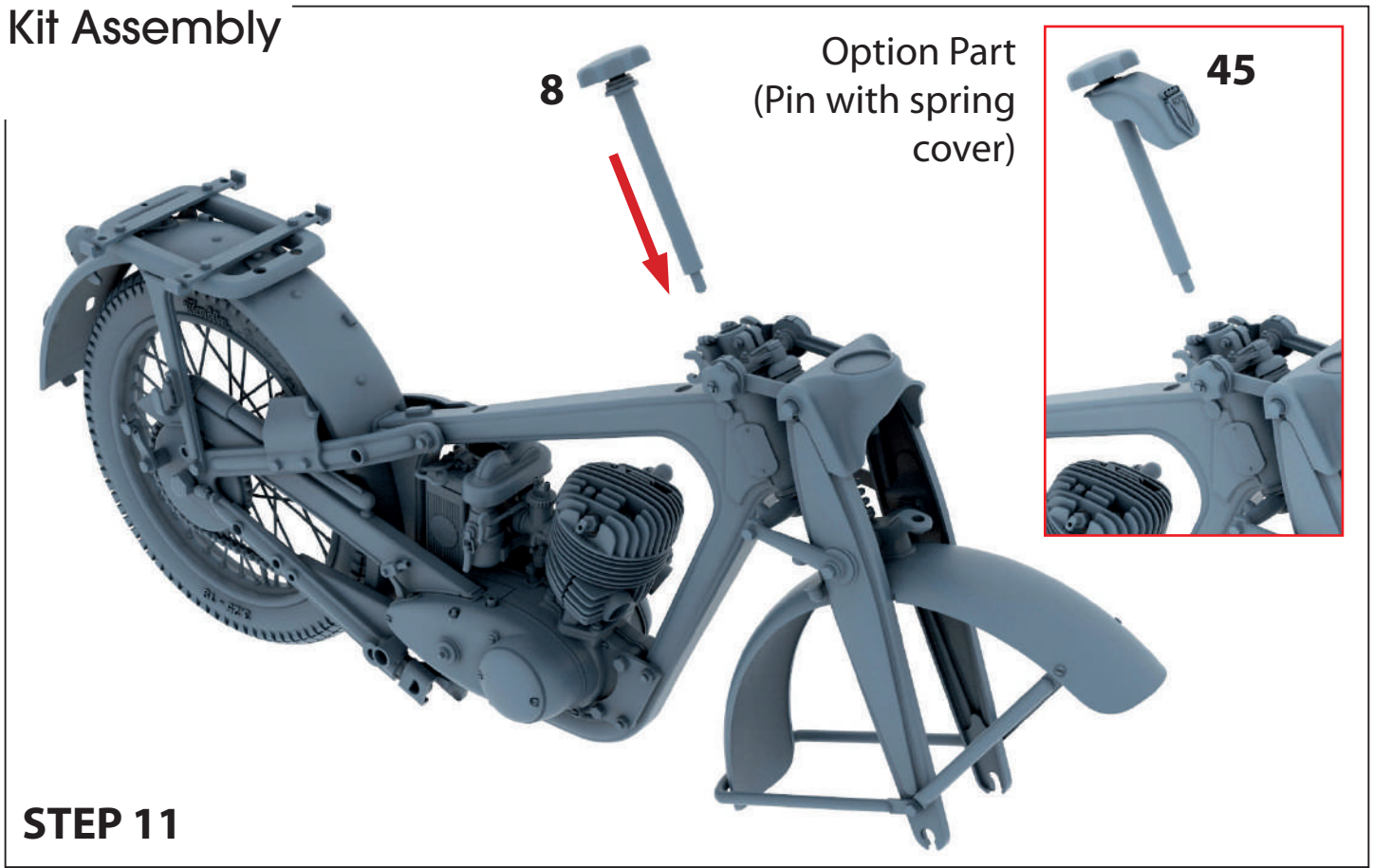

# Kit Assembly

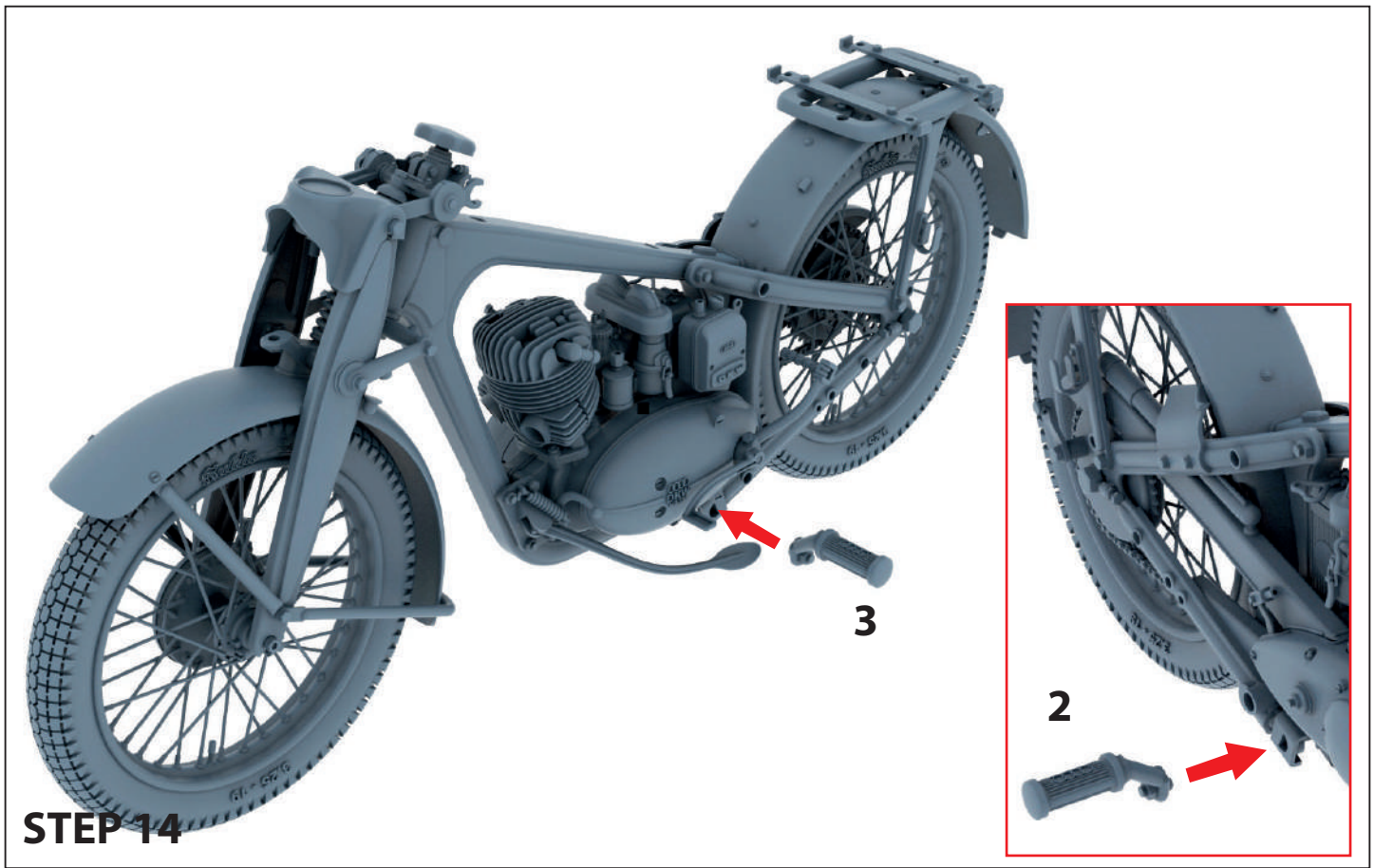
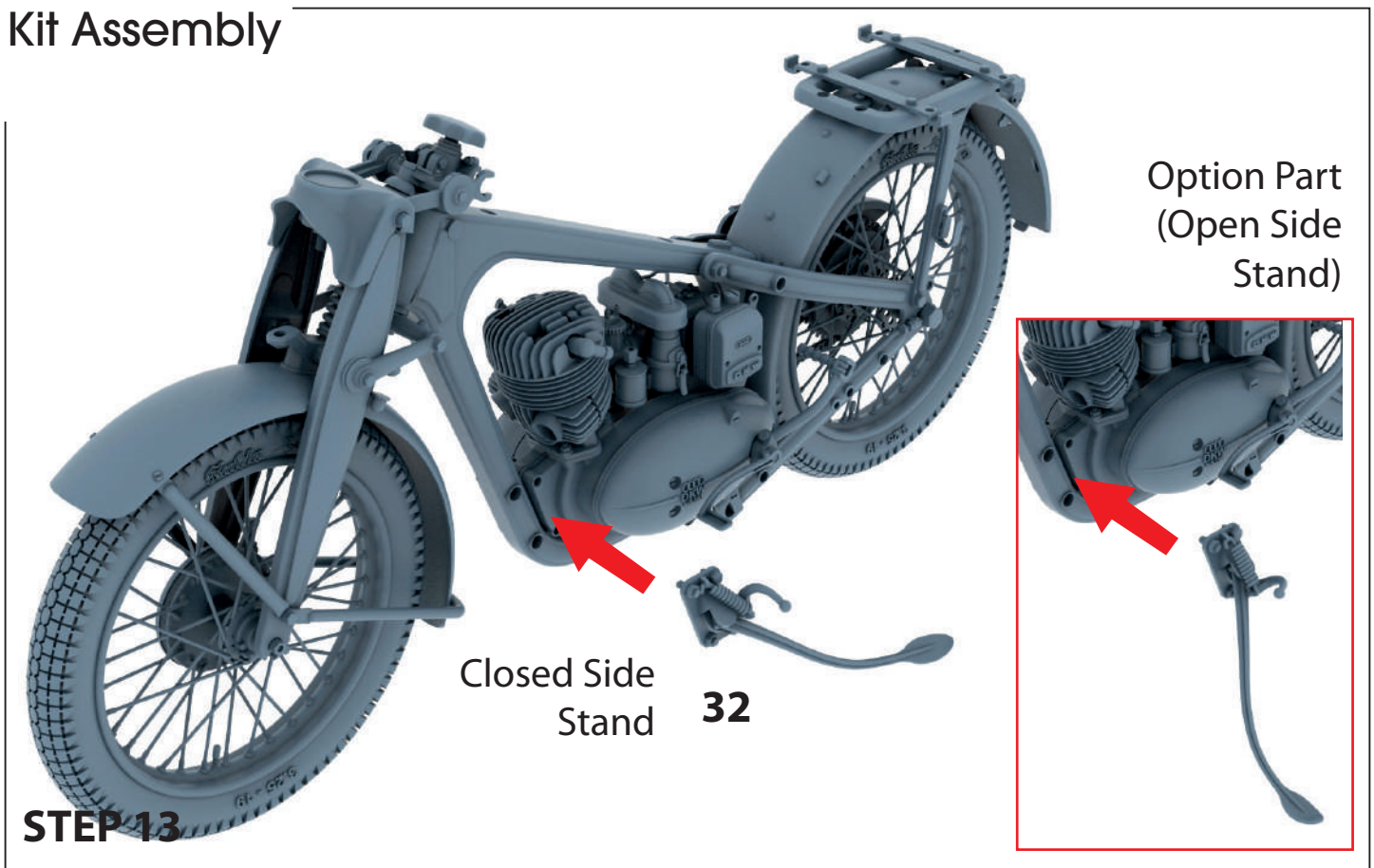

# Kit Assembly

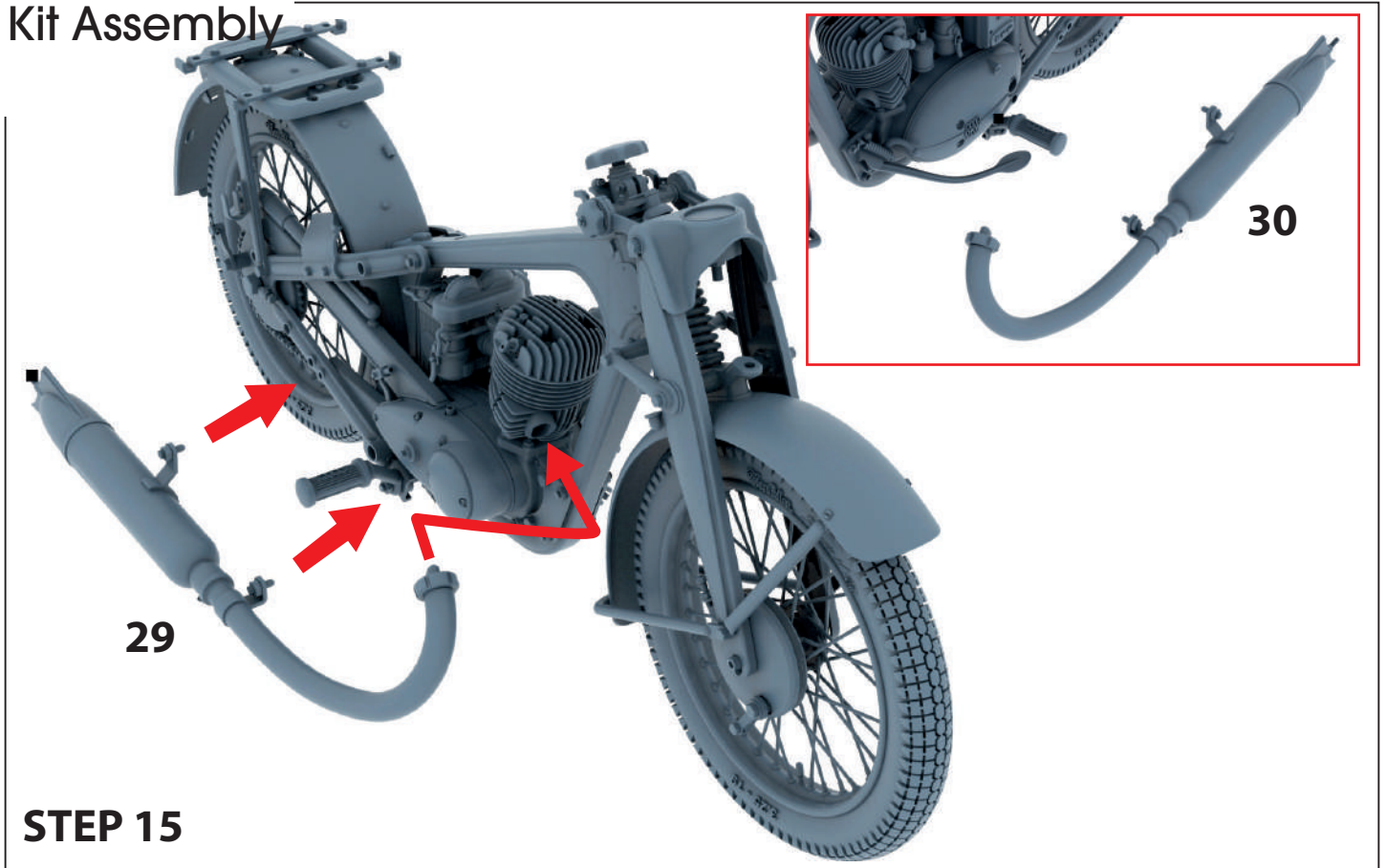

# Kit Assembly

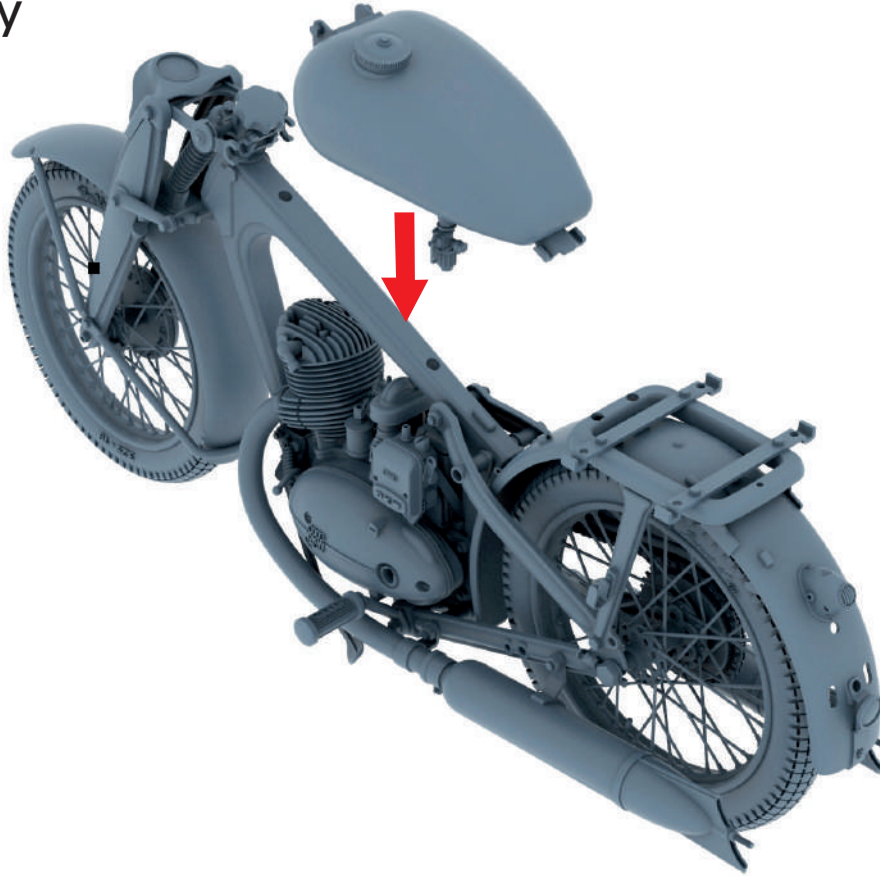

**STEP 17**

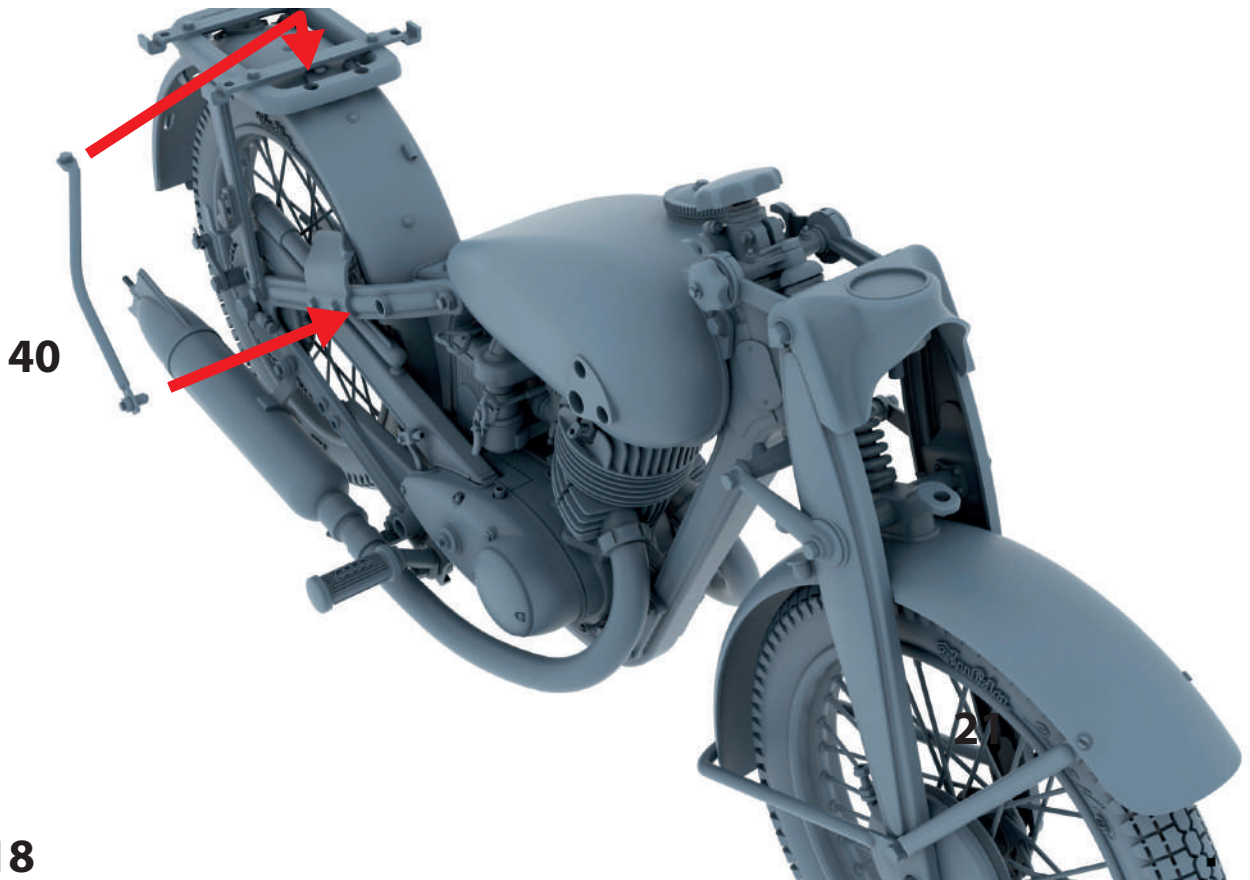

**STEP 18**

# Kit Assembly

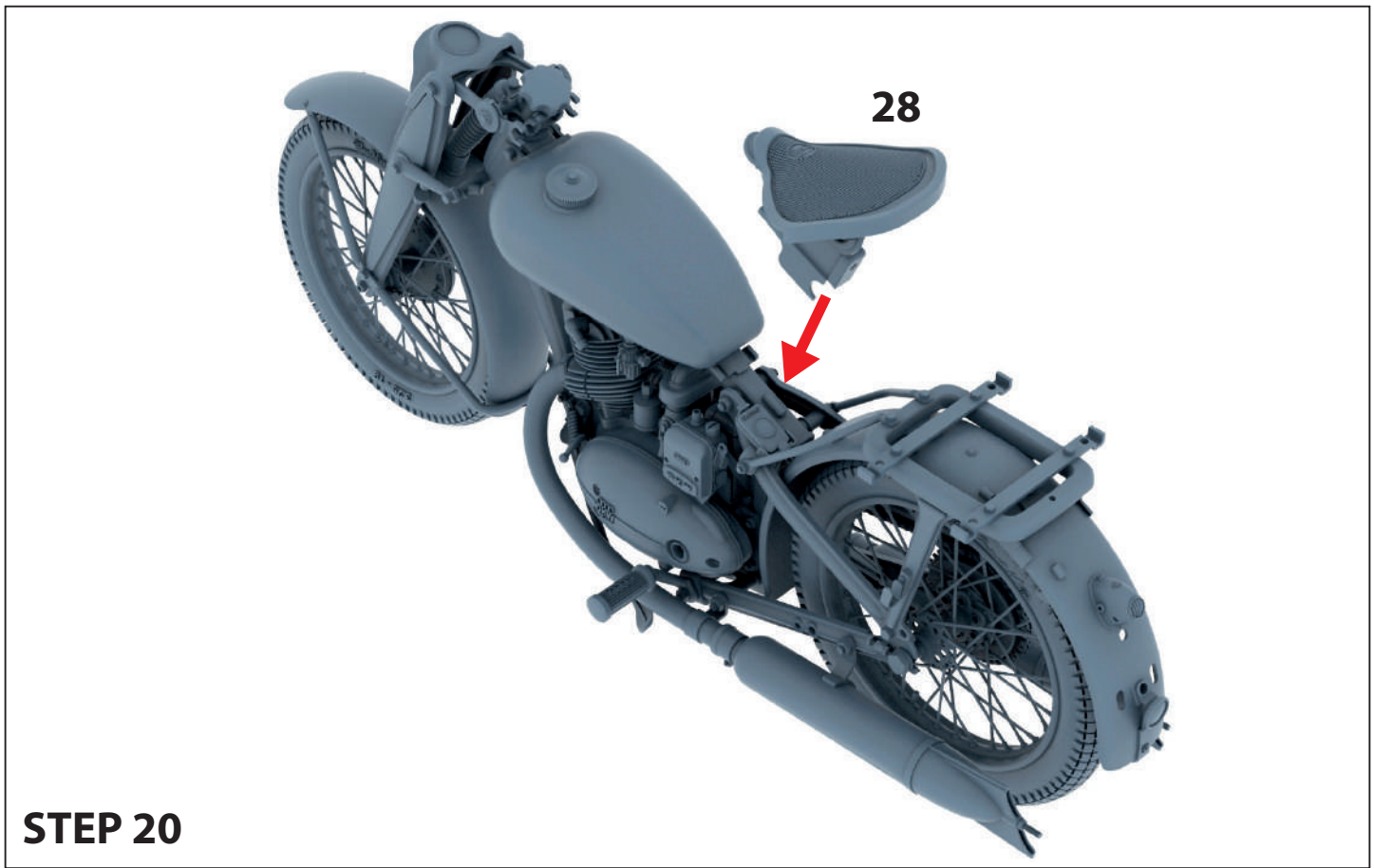
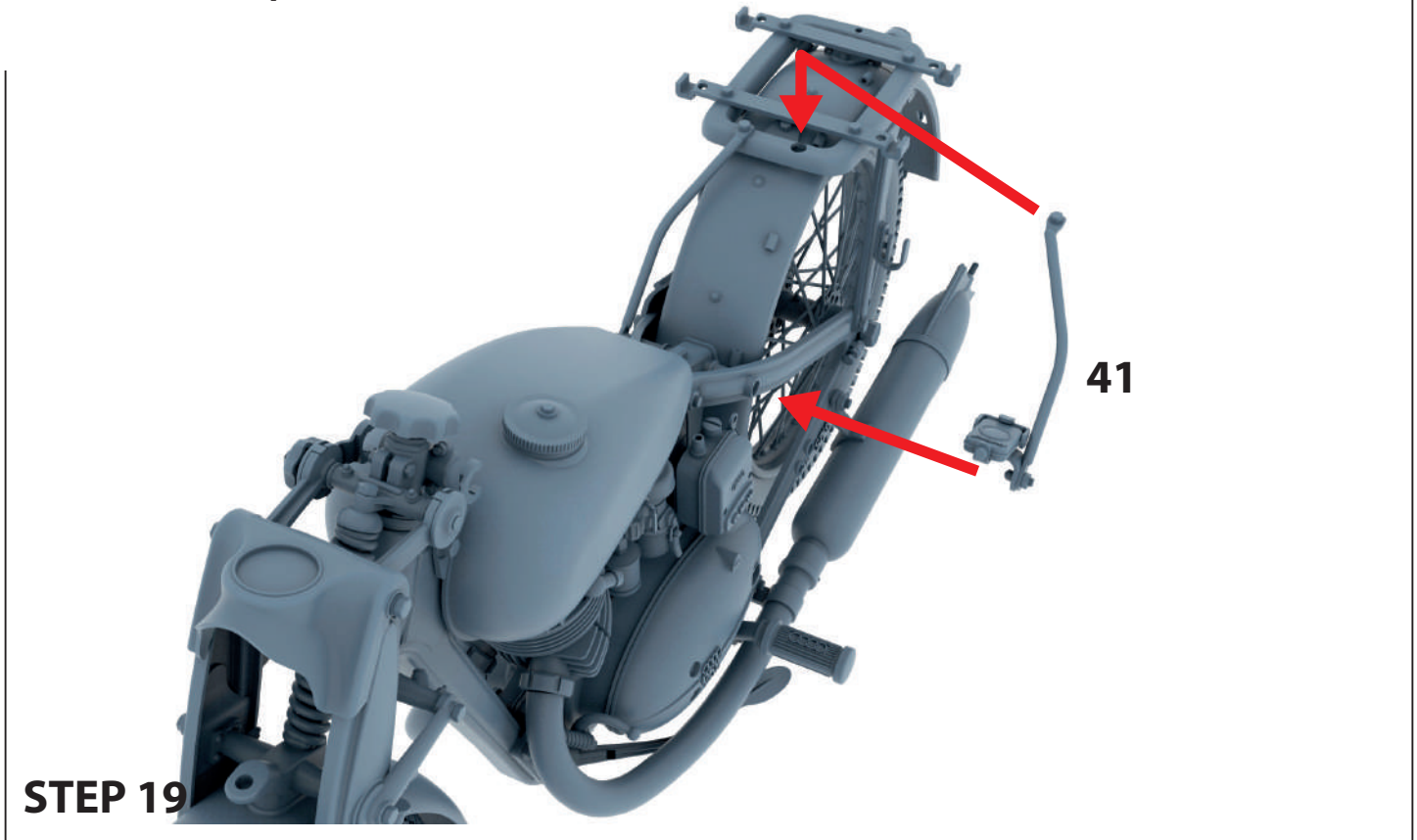

# Kit Assembly

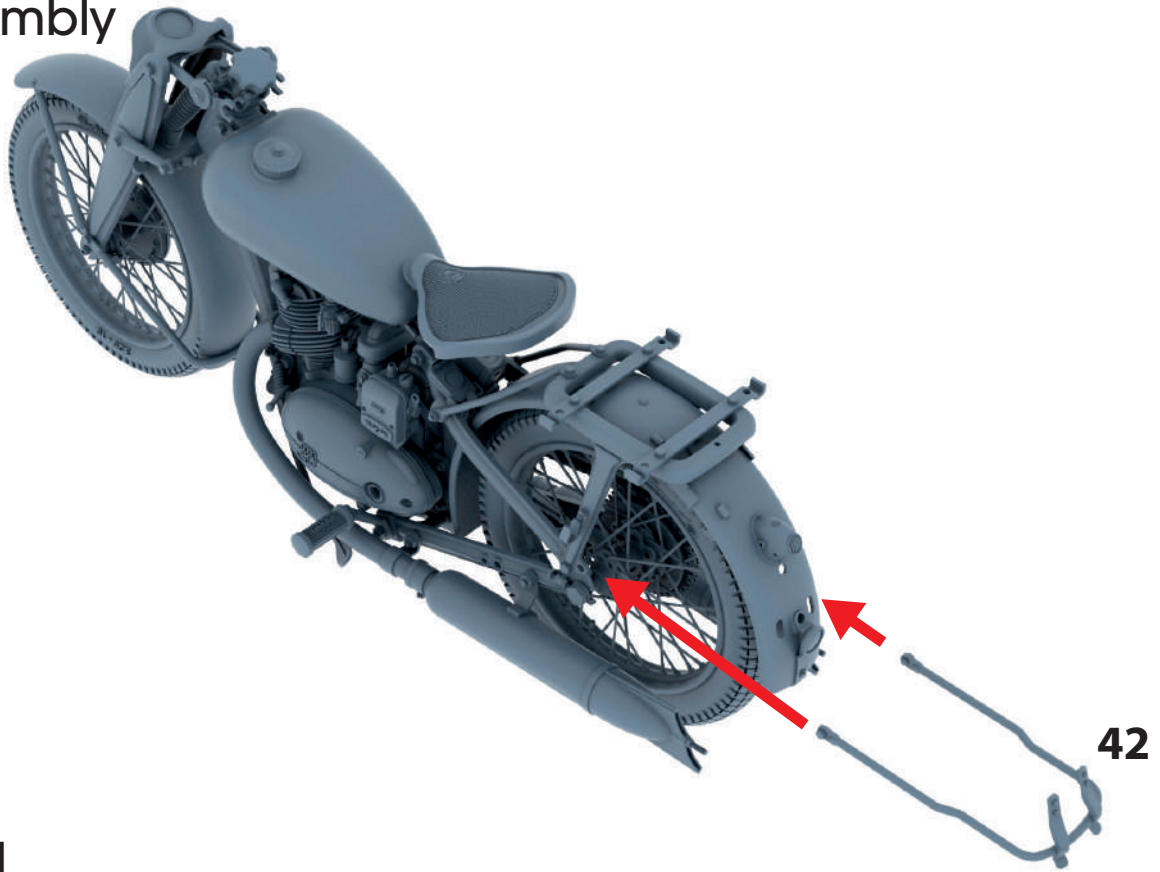

**STEP 21**

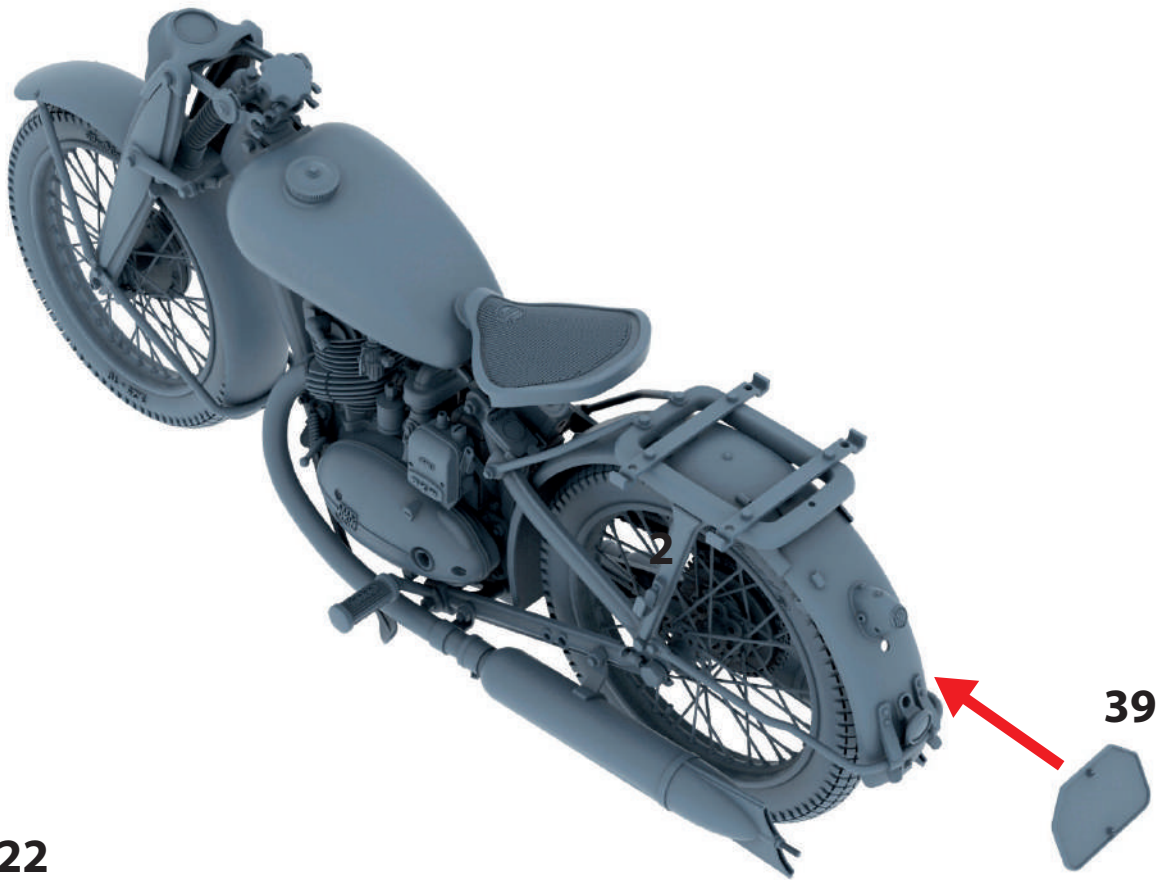

**STEP 22**

# Kit Assembly

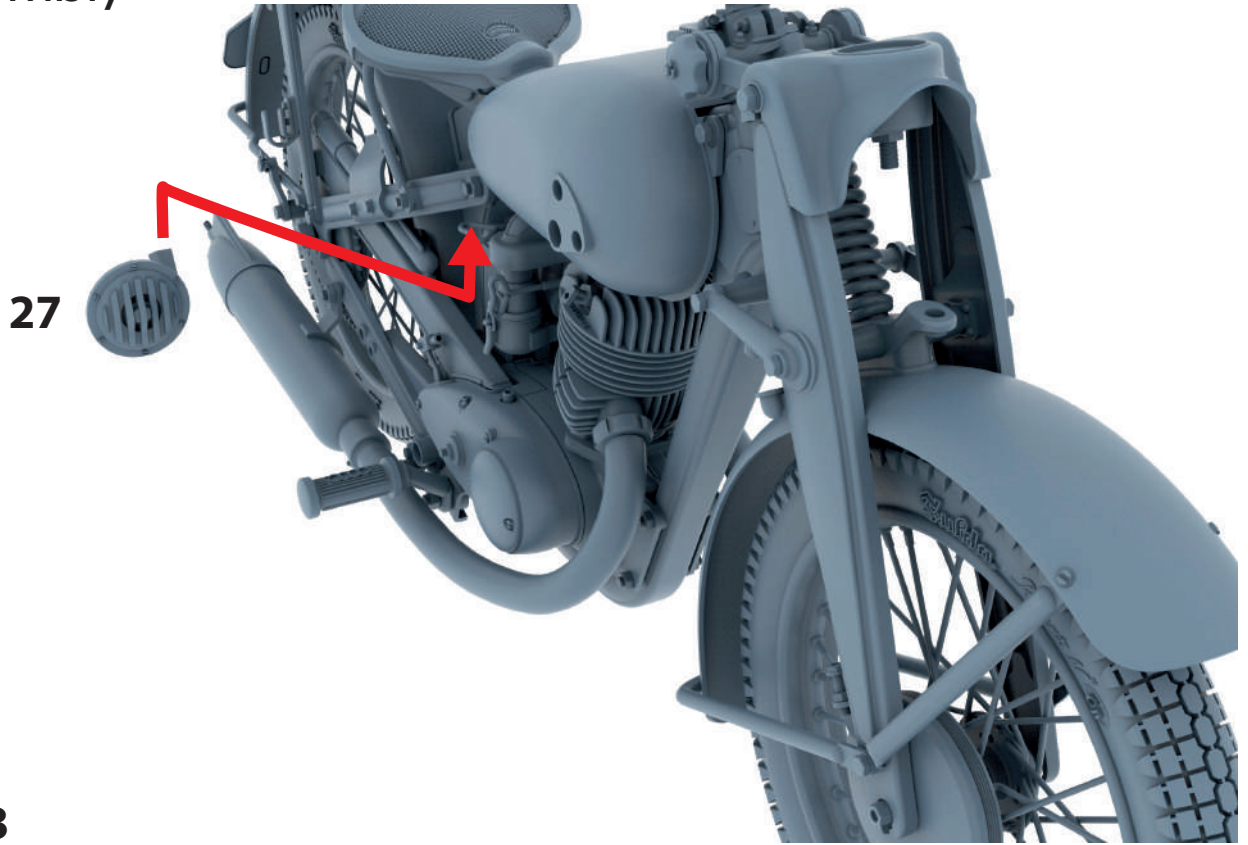

**STEP 23**

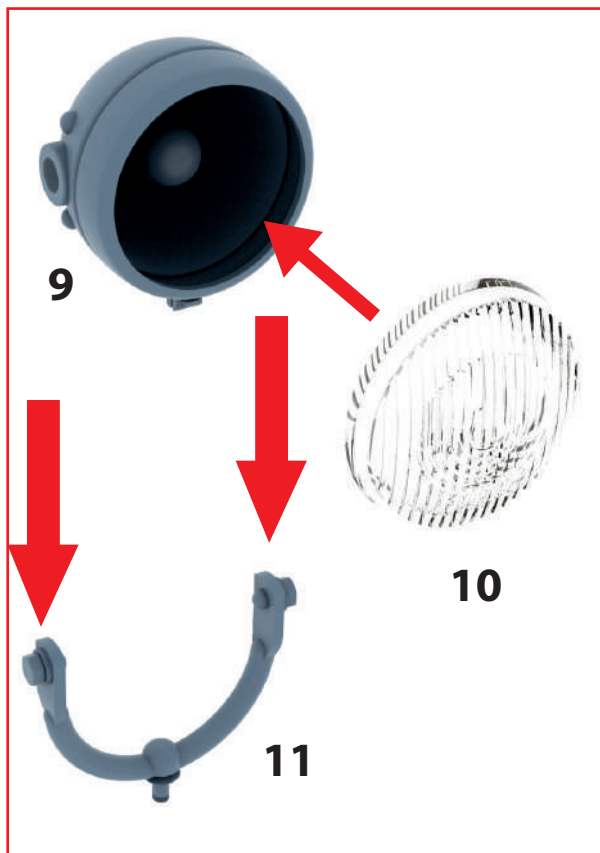

**STEP 24**

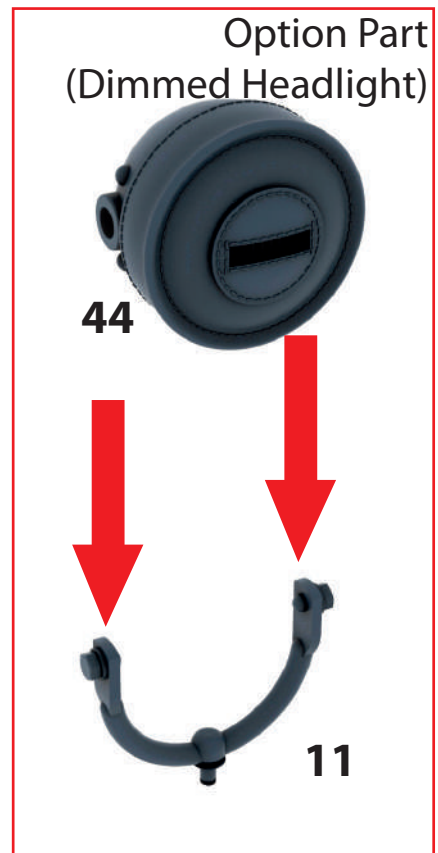

# Kit Assembly

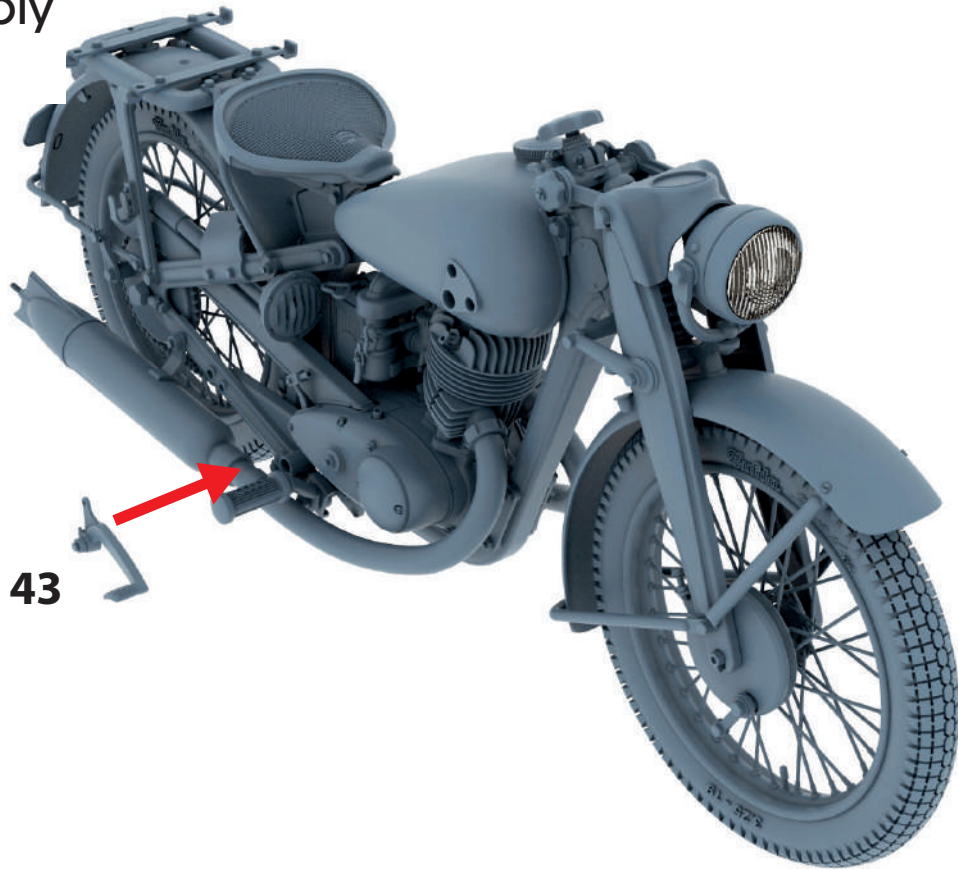

**STEP 25**

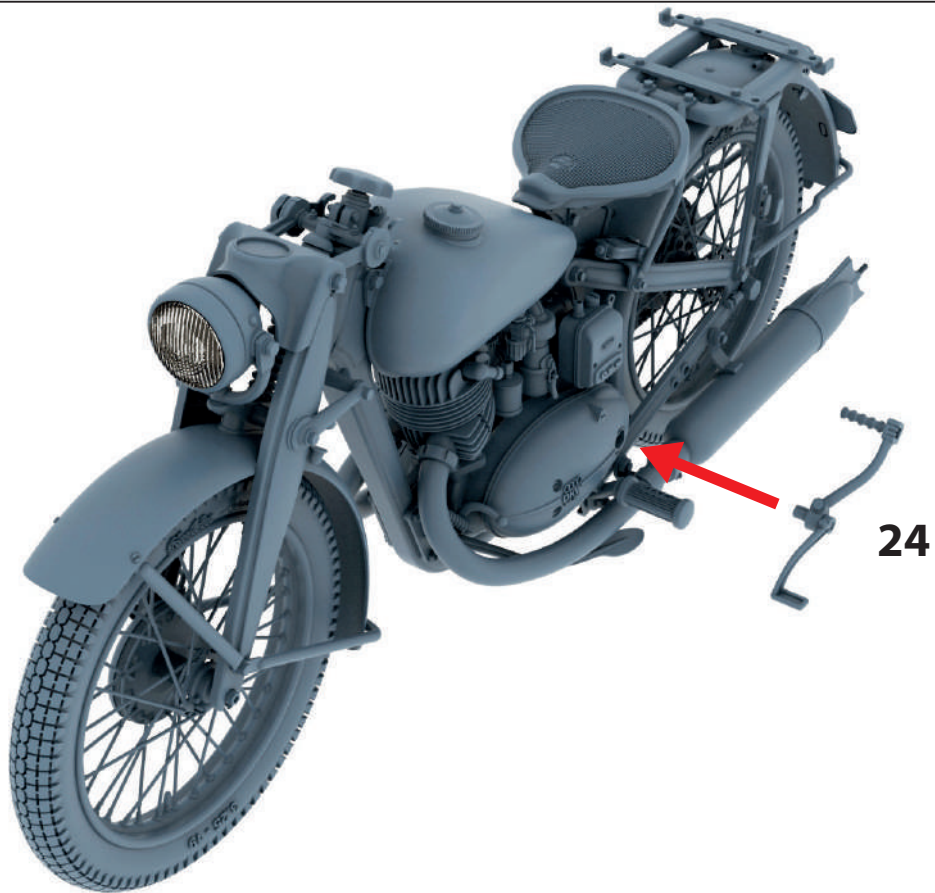

**STEP 26**

# Kit Assembly

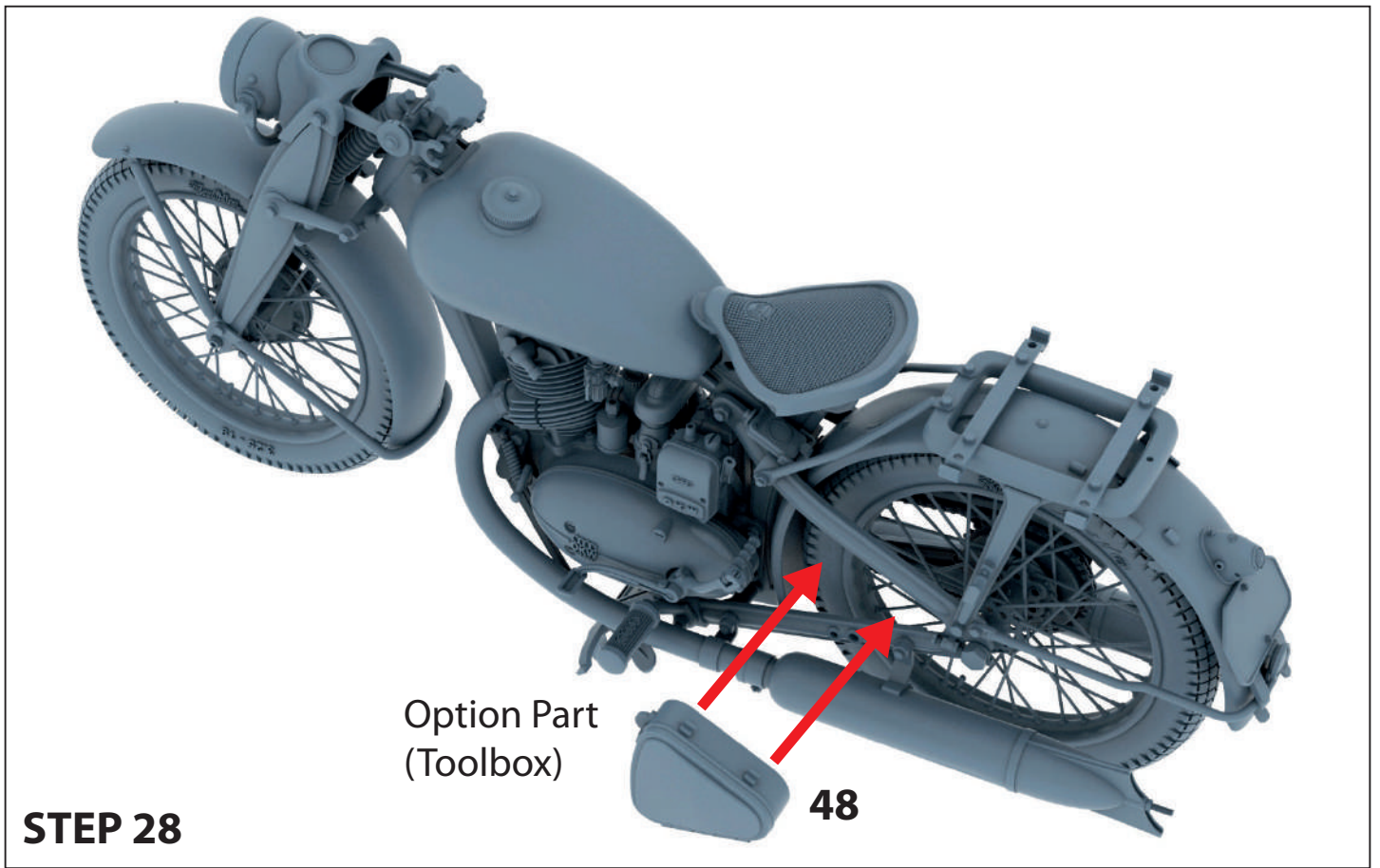
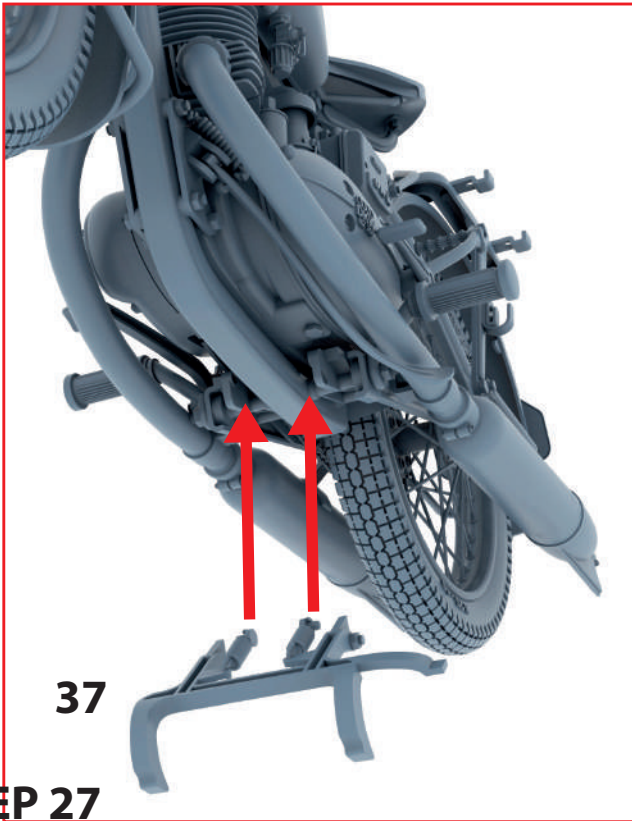

# Kit Assembly

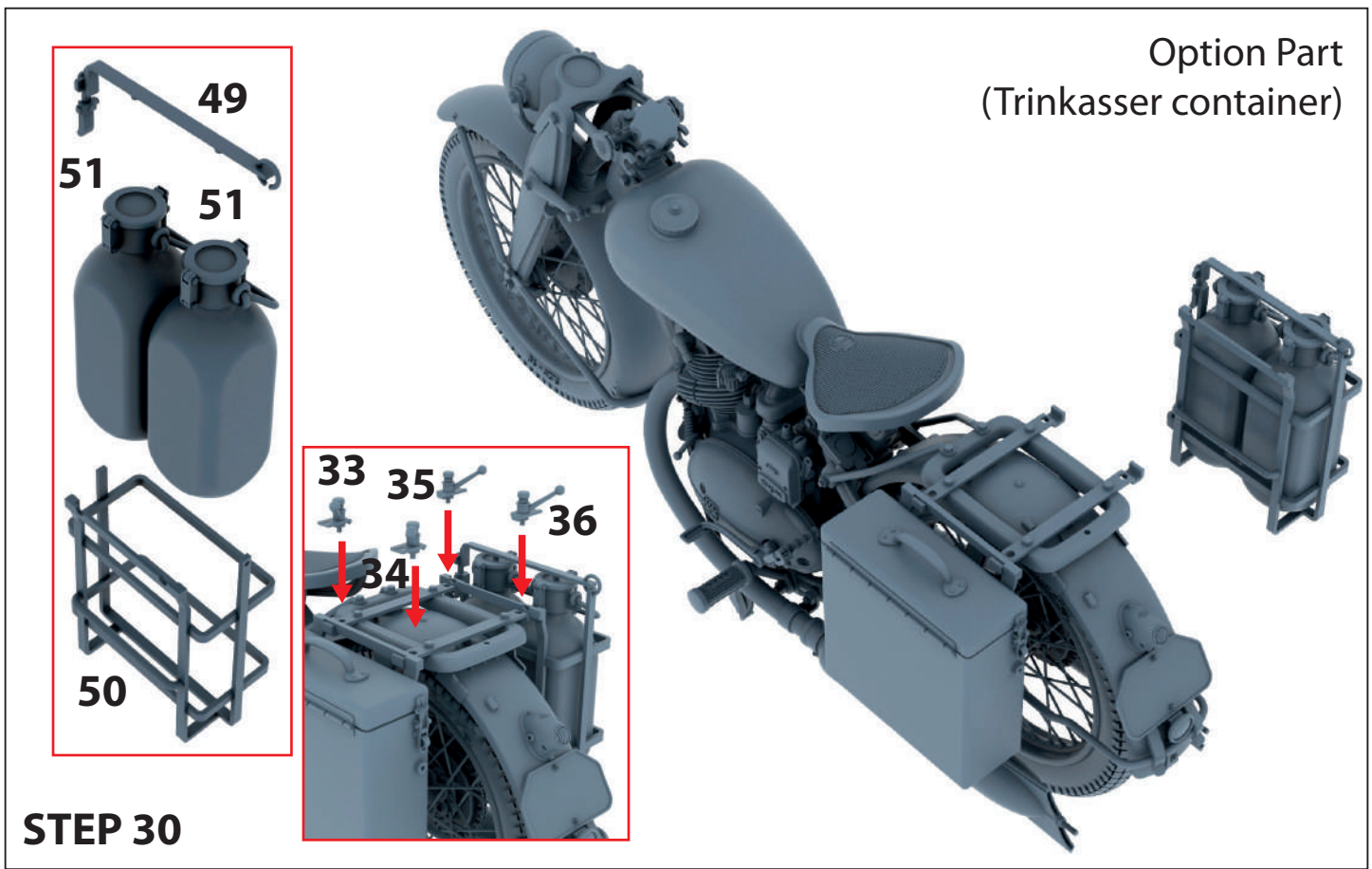
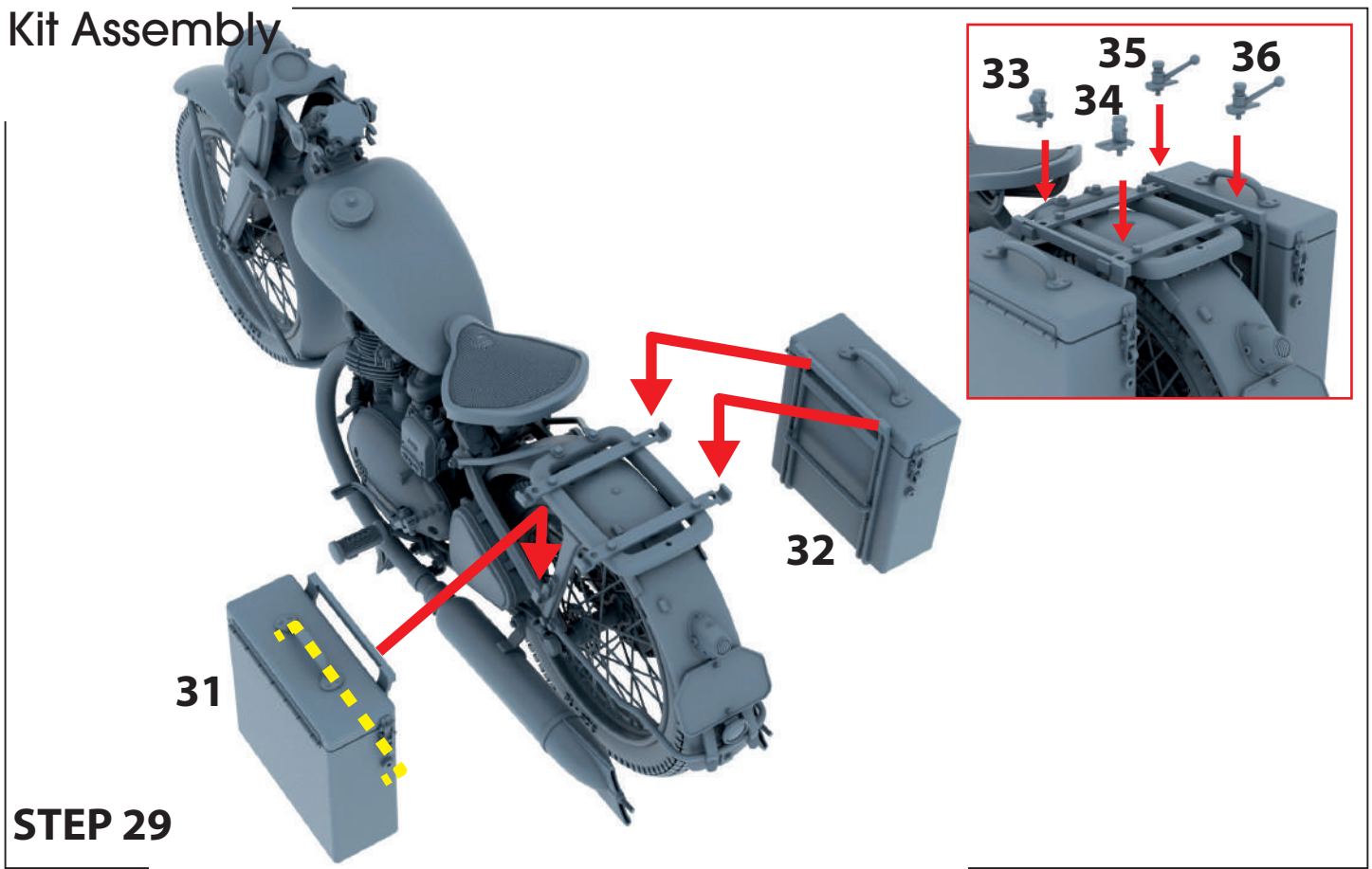

# Kit Assembly

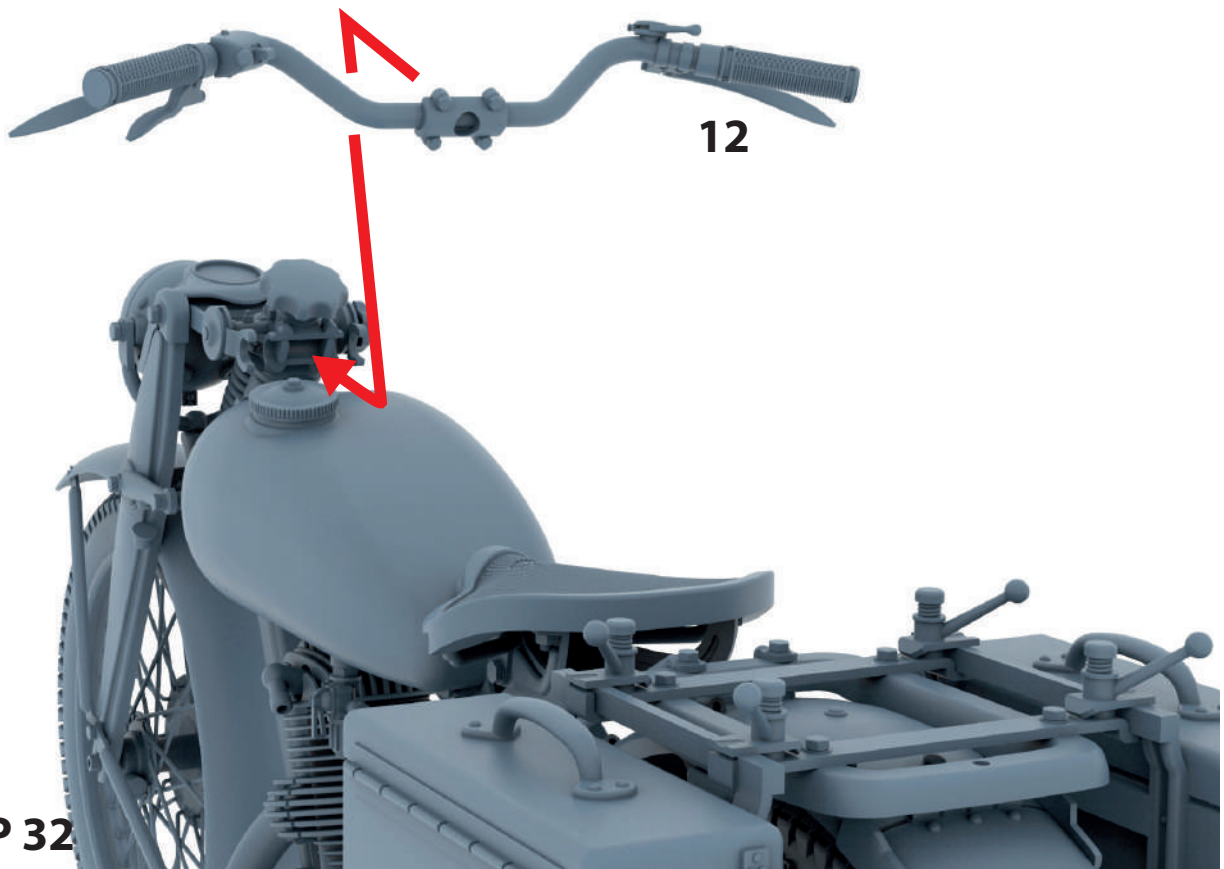
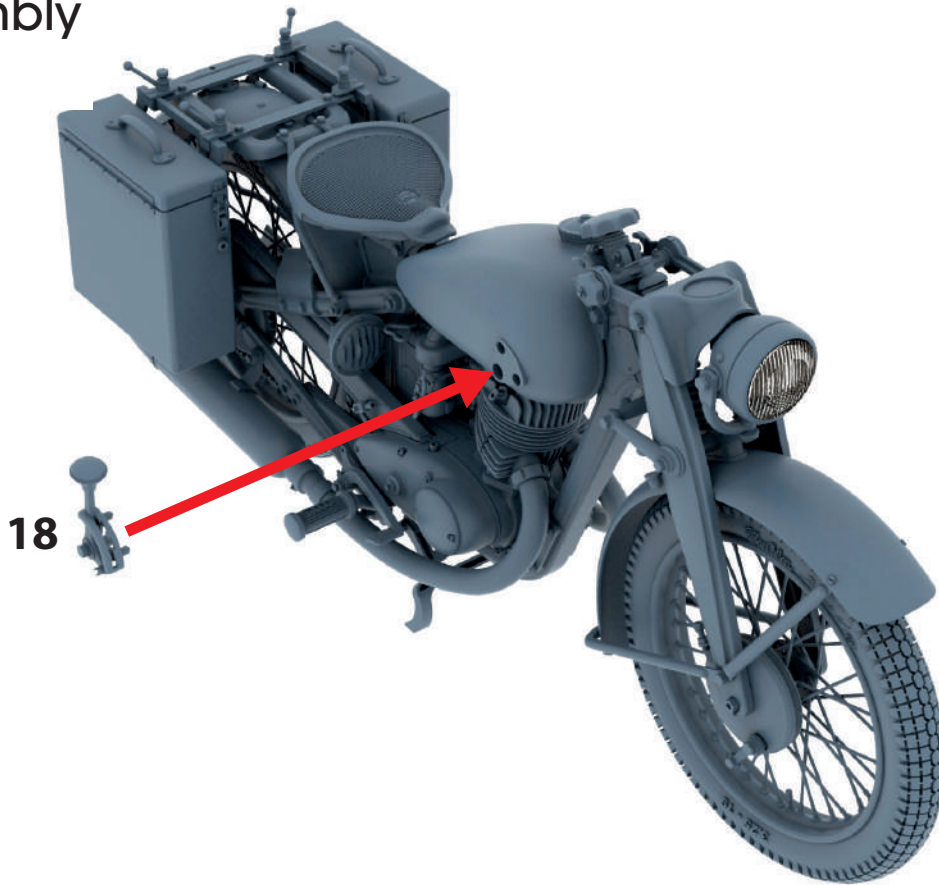

## Side Views

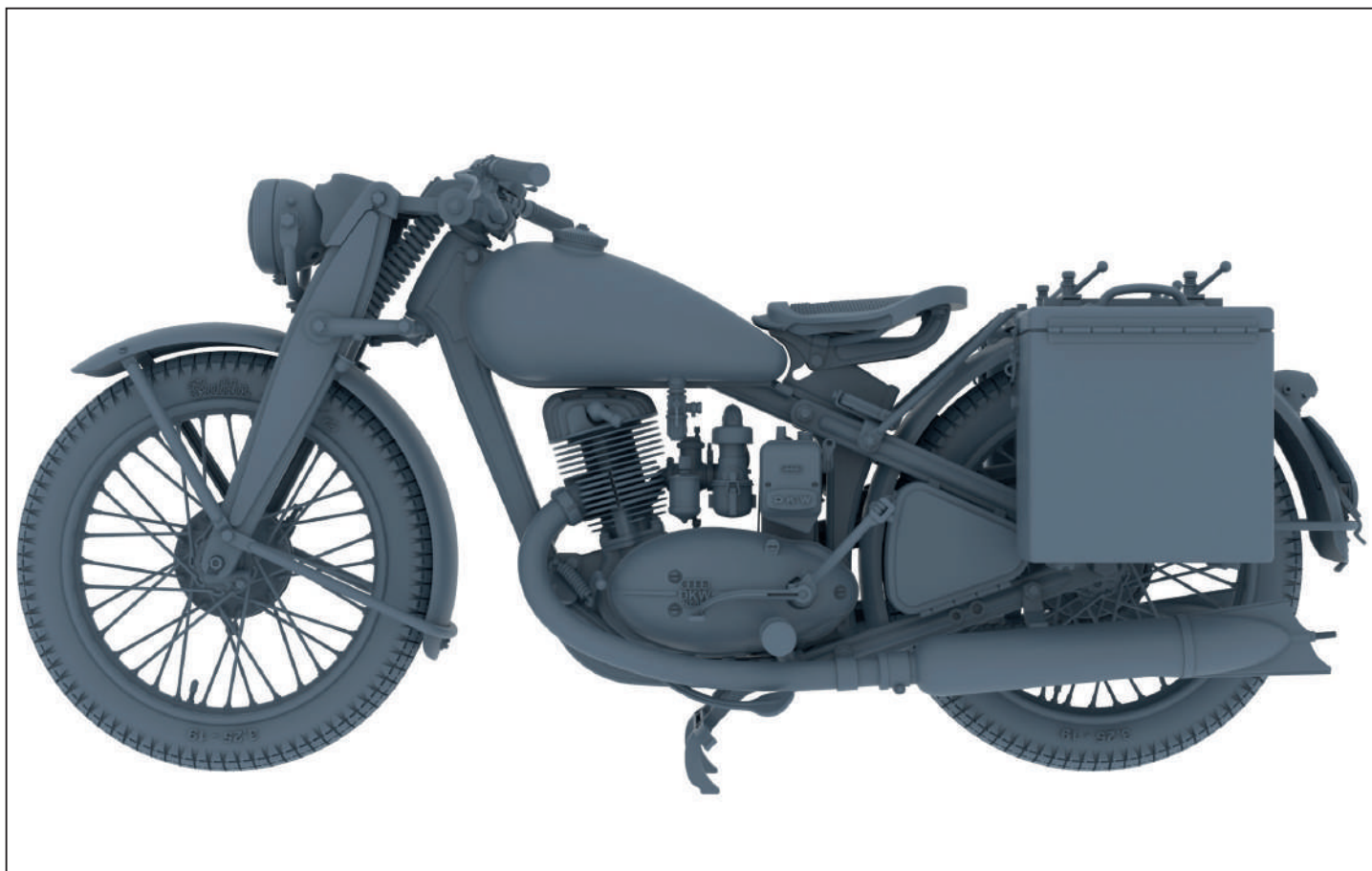
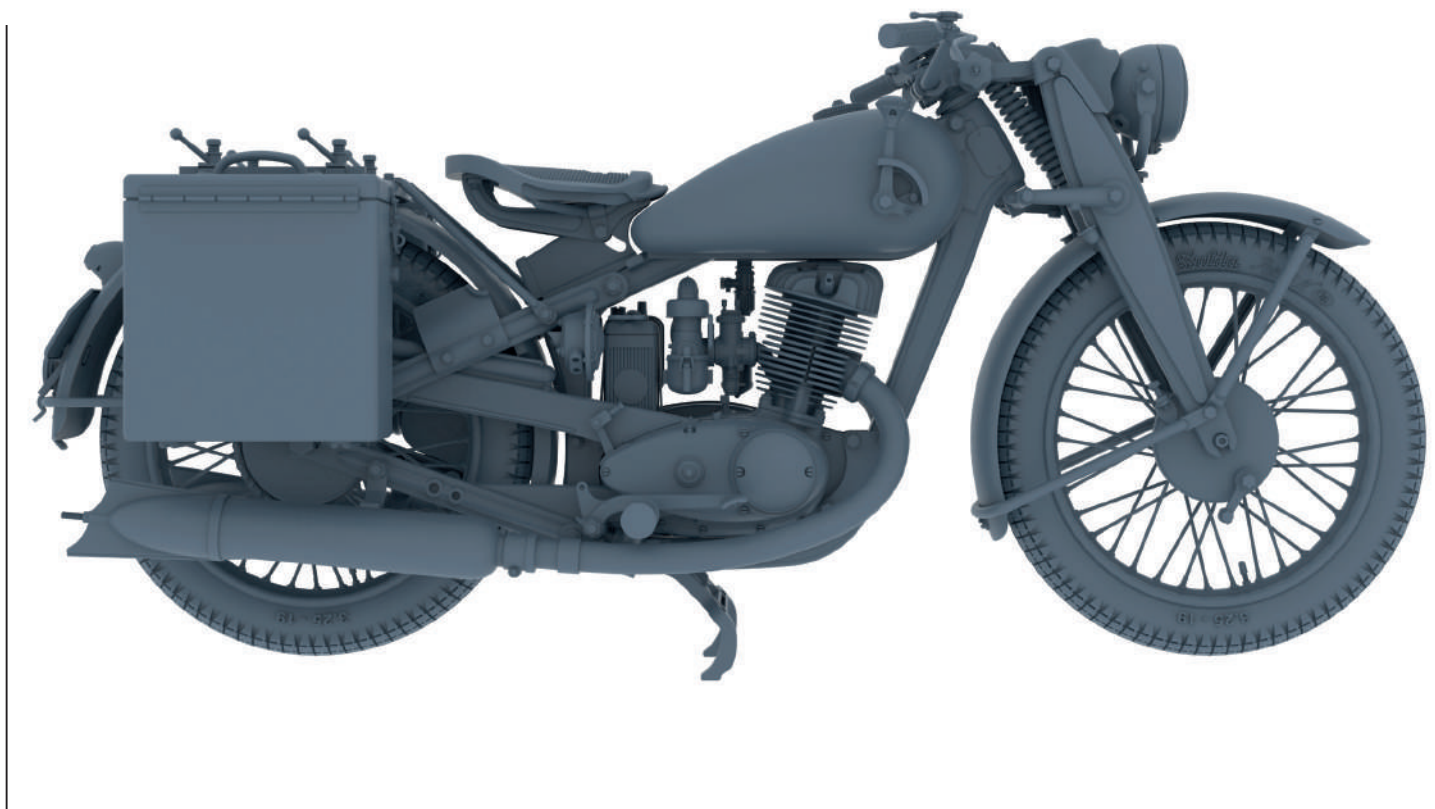

# Decals (Dunkelgelb/Camo)

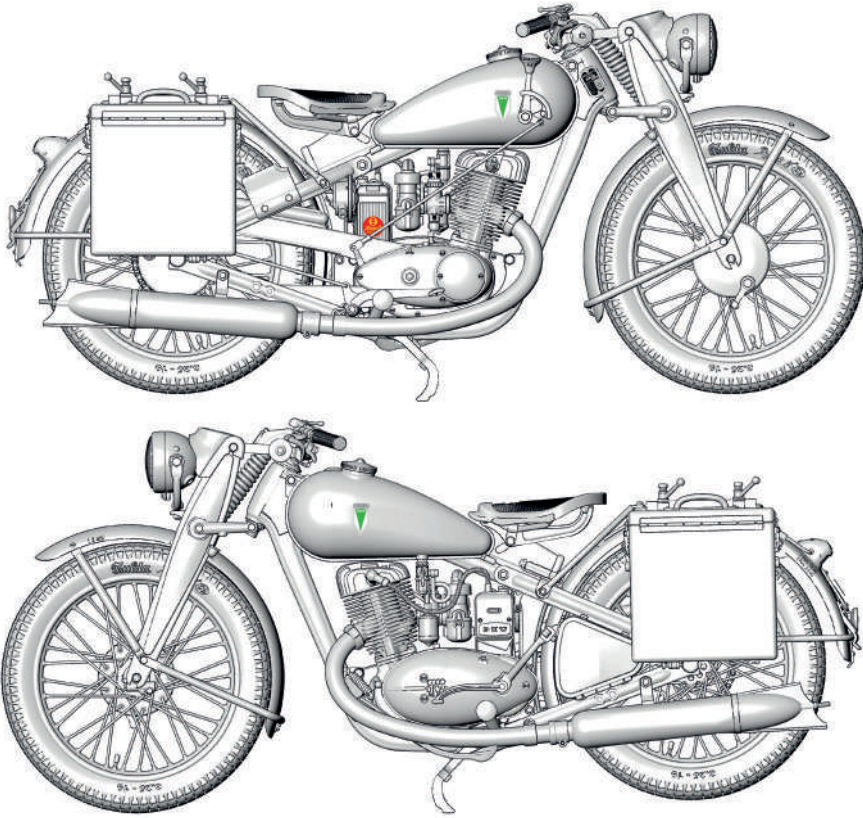

Option 1  
Tank Decal

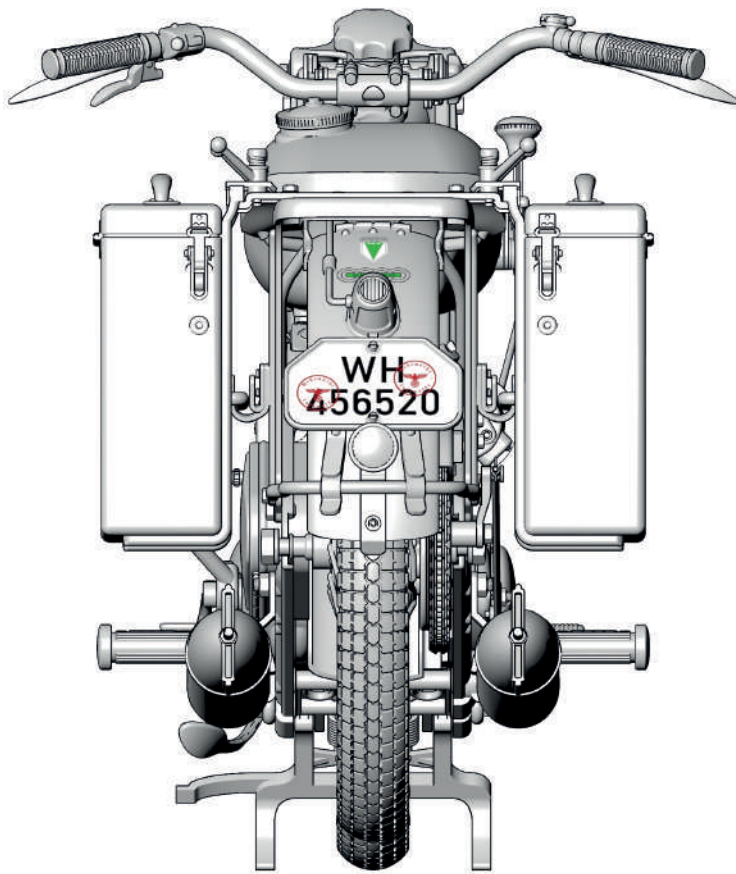
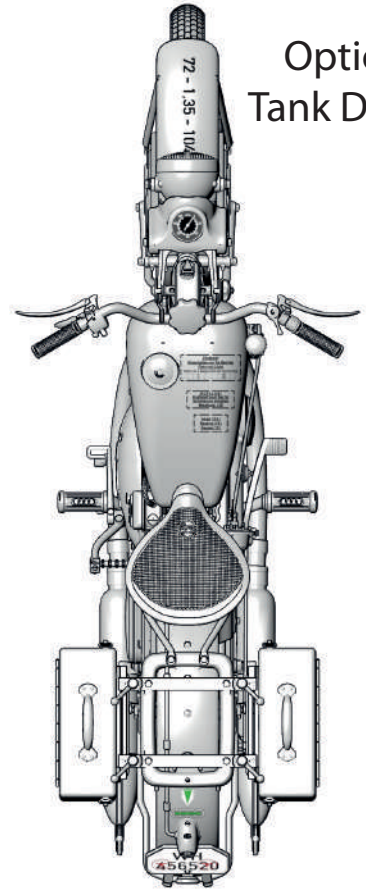

Option 2  
Tank Decal

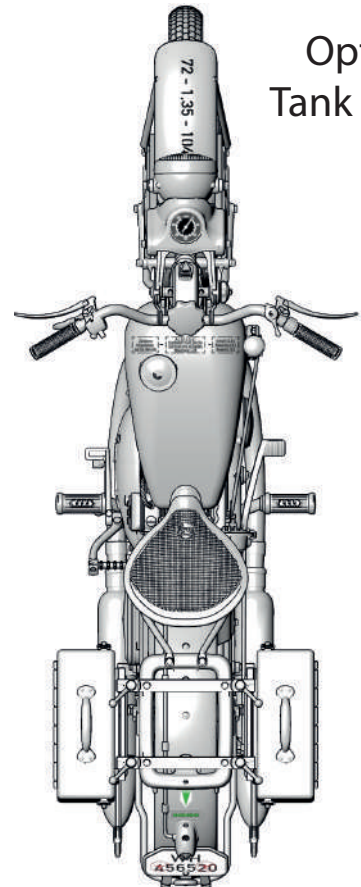

# Decals (Dunkelgrau)

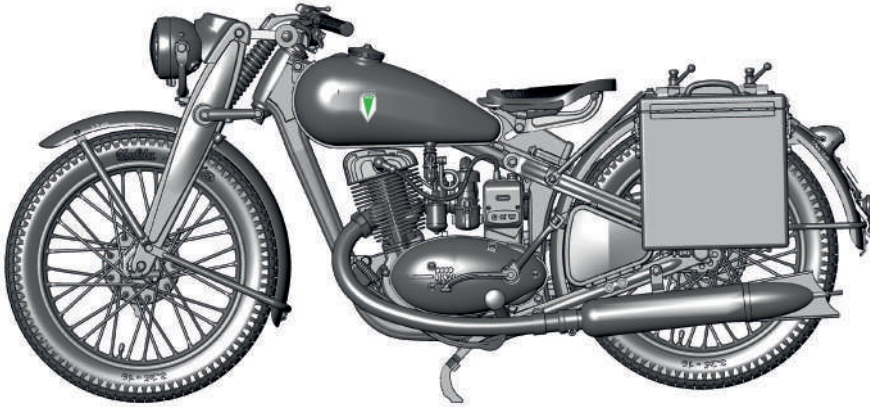
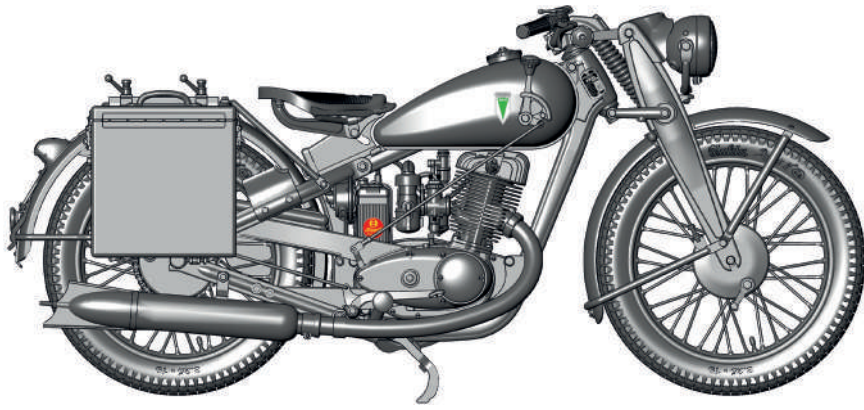

Option 1  
Tank Decal

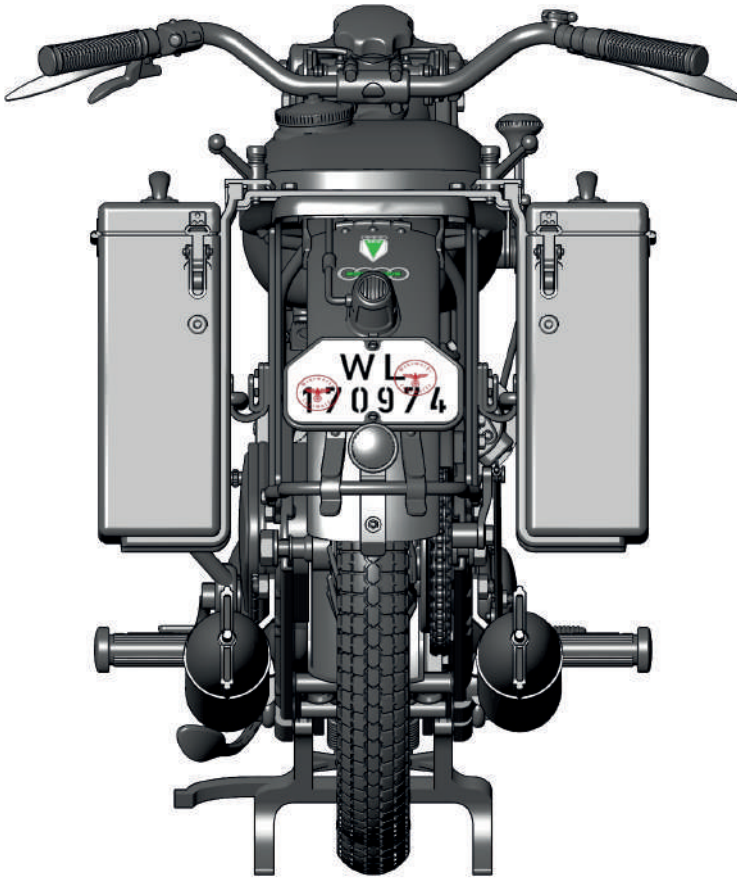

Option 2  
Tank Decal

# Cables scheme

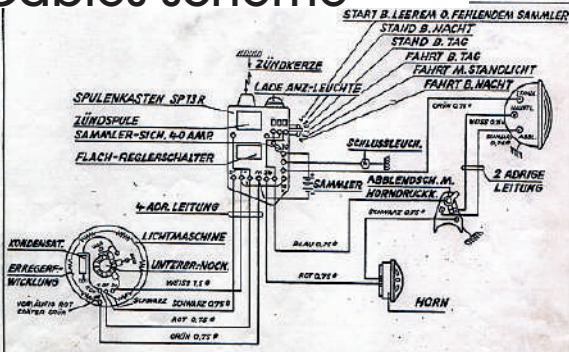

SCHALTBILD RT 125 UND NZ 350 - 7.  
Original Electric Cable Scheme

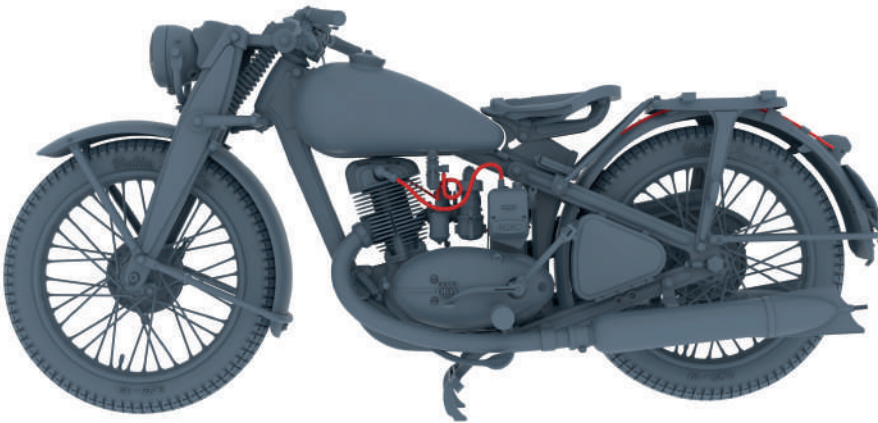
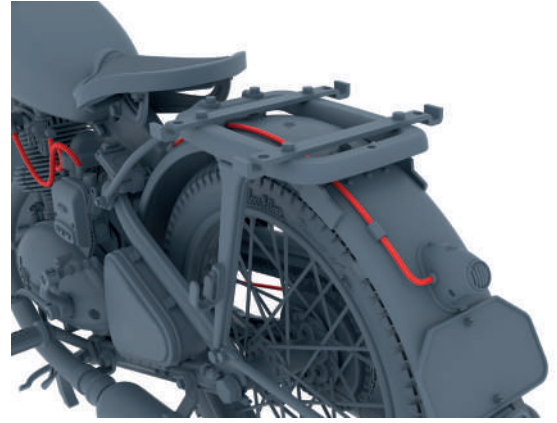
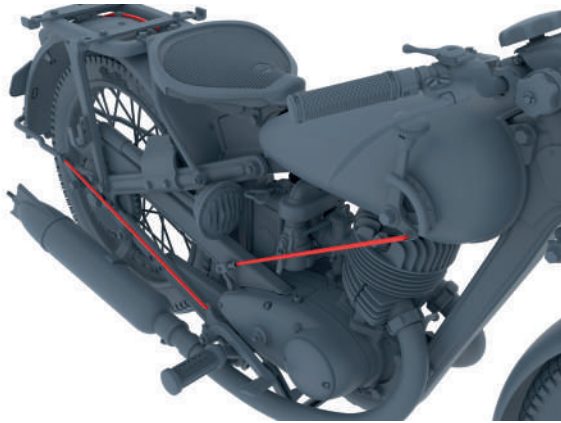
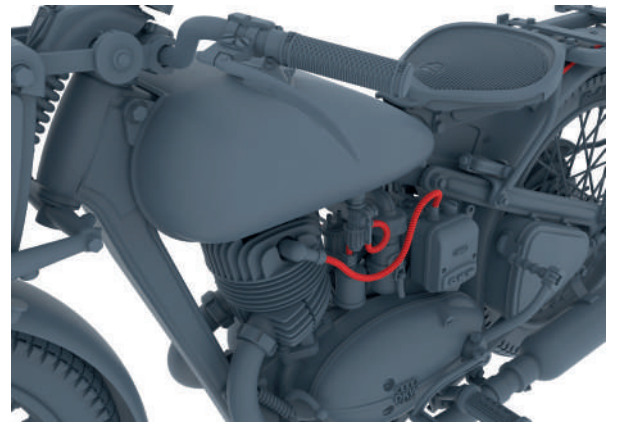

# Walkaround



# Walkaround



# Walkaround

